

KROFTMAN CT-S-800

Assembly manual for end wall frame

Montageanleitung für Stirnwandrahmen

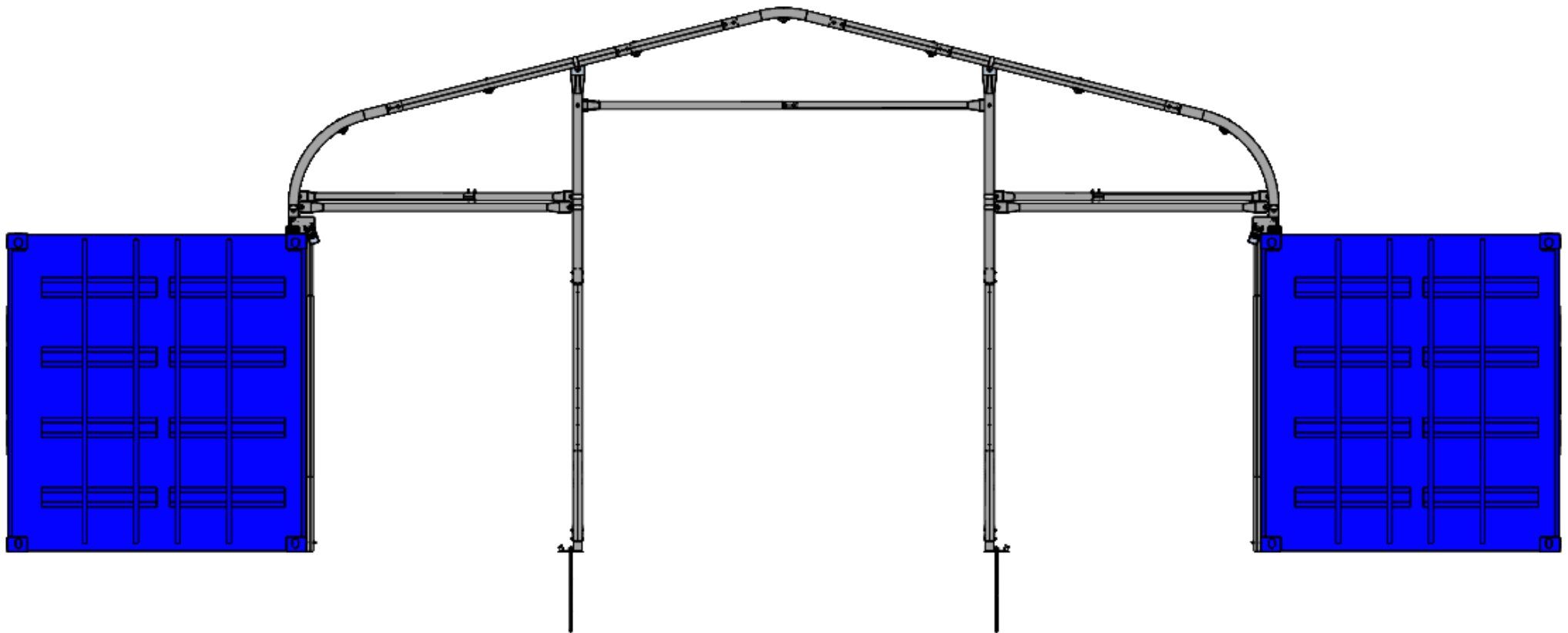

Manuel d'assemblage pour le cadre mural d'extrémité

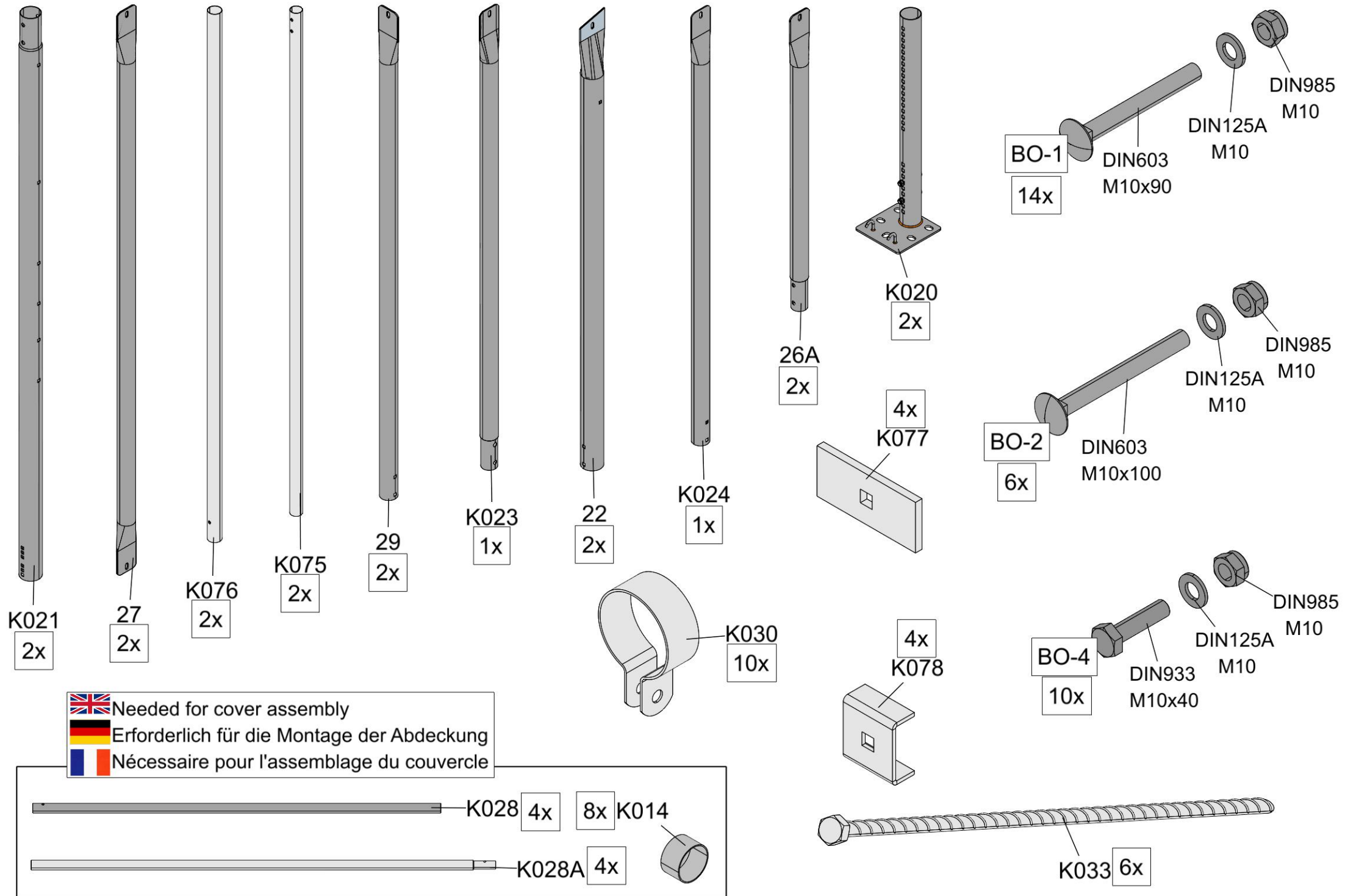

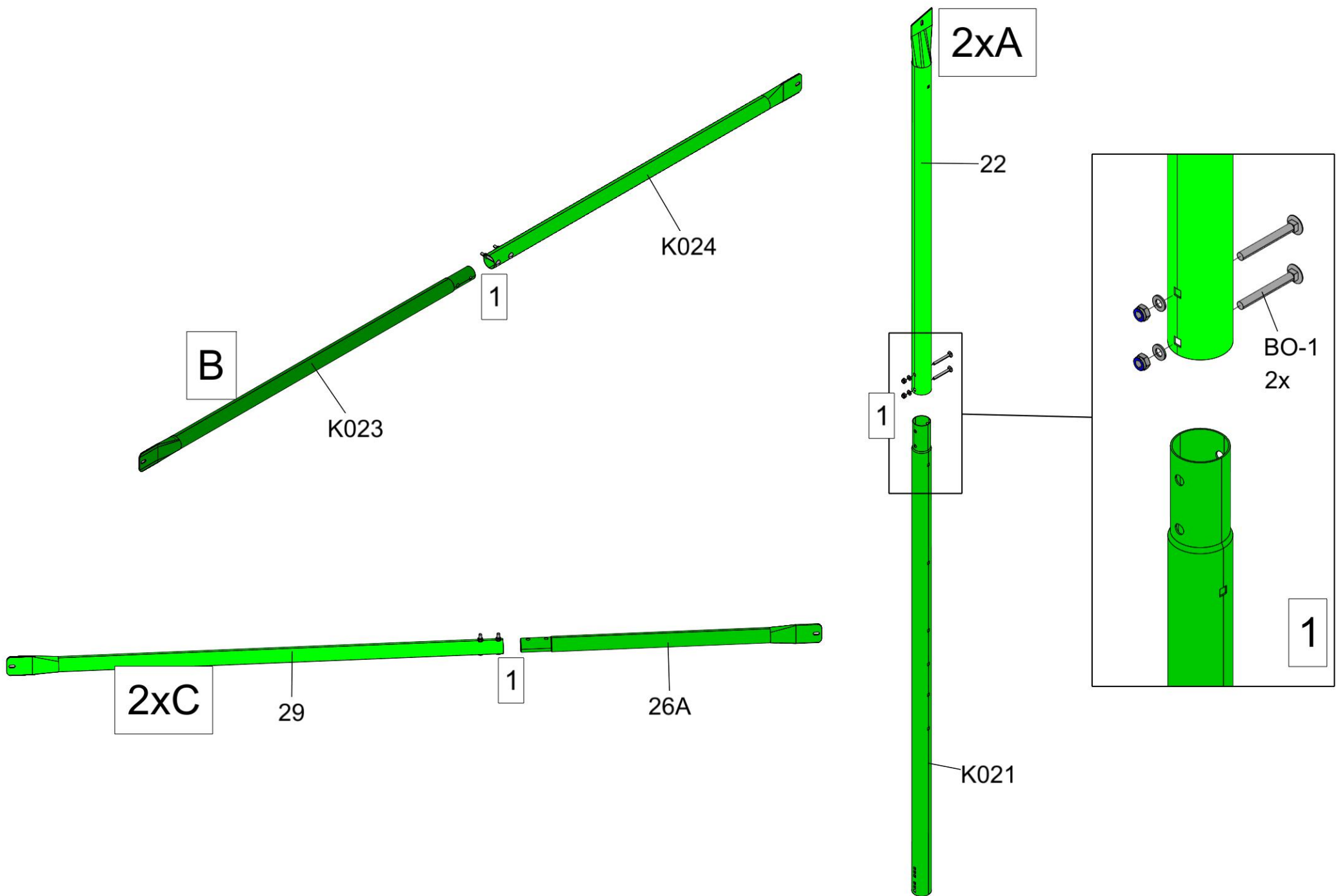

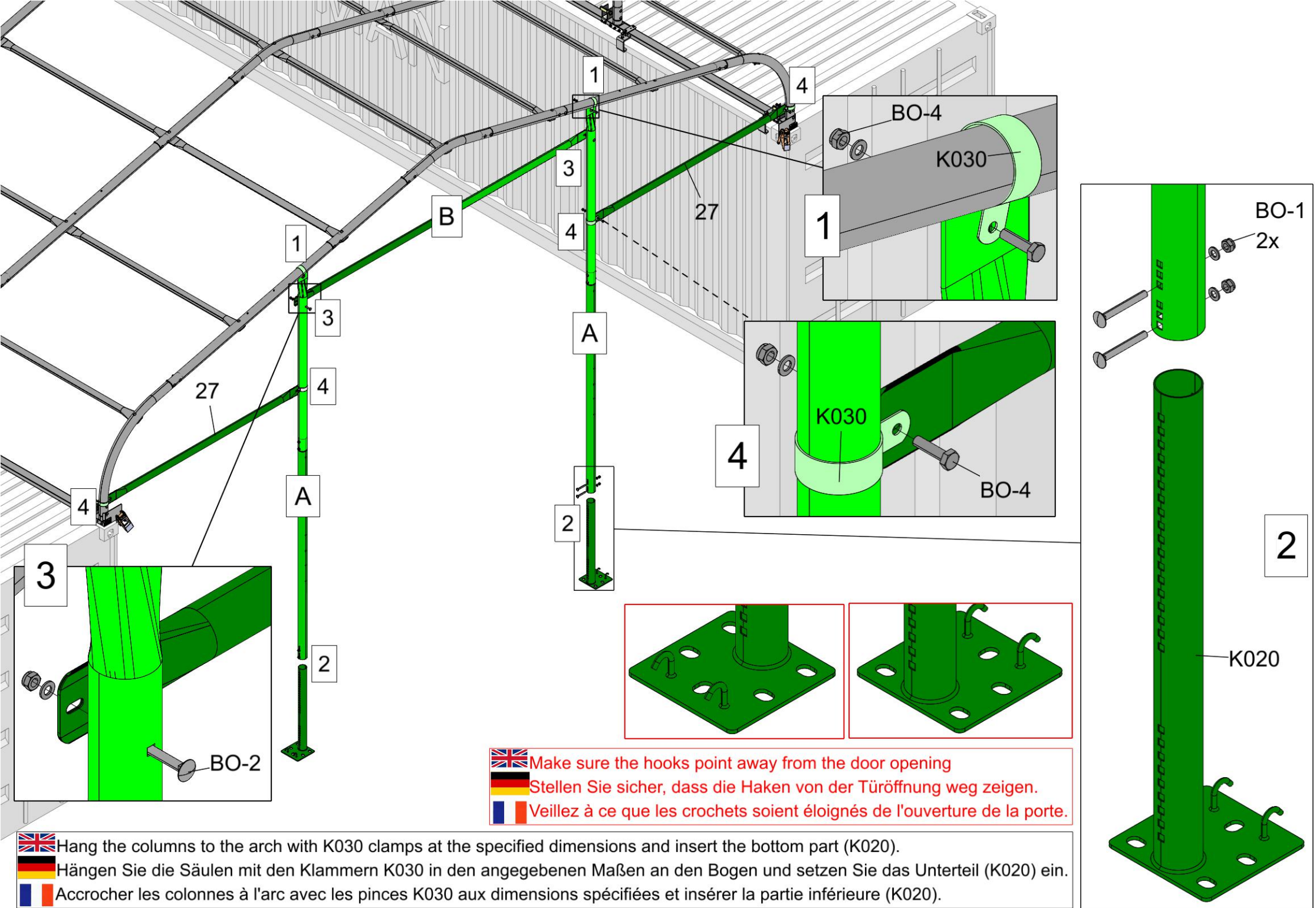





 Make sure the hooks point away from the door opening
 Stellen Sie sicher, dass die Haken von der Türöffnung weg zeigen.
 Veillez à ce que les crochets soient éloignés de l'ouverture de la porte.

 Hang the columns to the arch with K030 clamps at the specified dimensions and insert the bottom part (K020).
 Hängen Sie die Säulen mit den Klammern K030 in den angegebenen Maßen an den Bogen und setzen Sie das Unterteil (K020) ein.
 Accrocher les colonnes à l'arc avec les pinces K030 aux dimensions spécifiées et insérer la partie inférieure (K020).

