

# KROFTMAN WB-400-CL

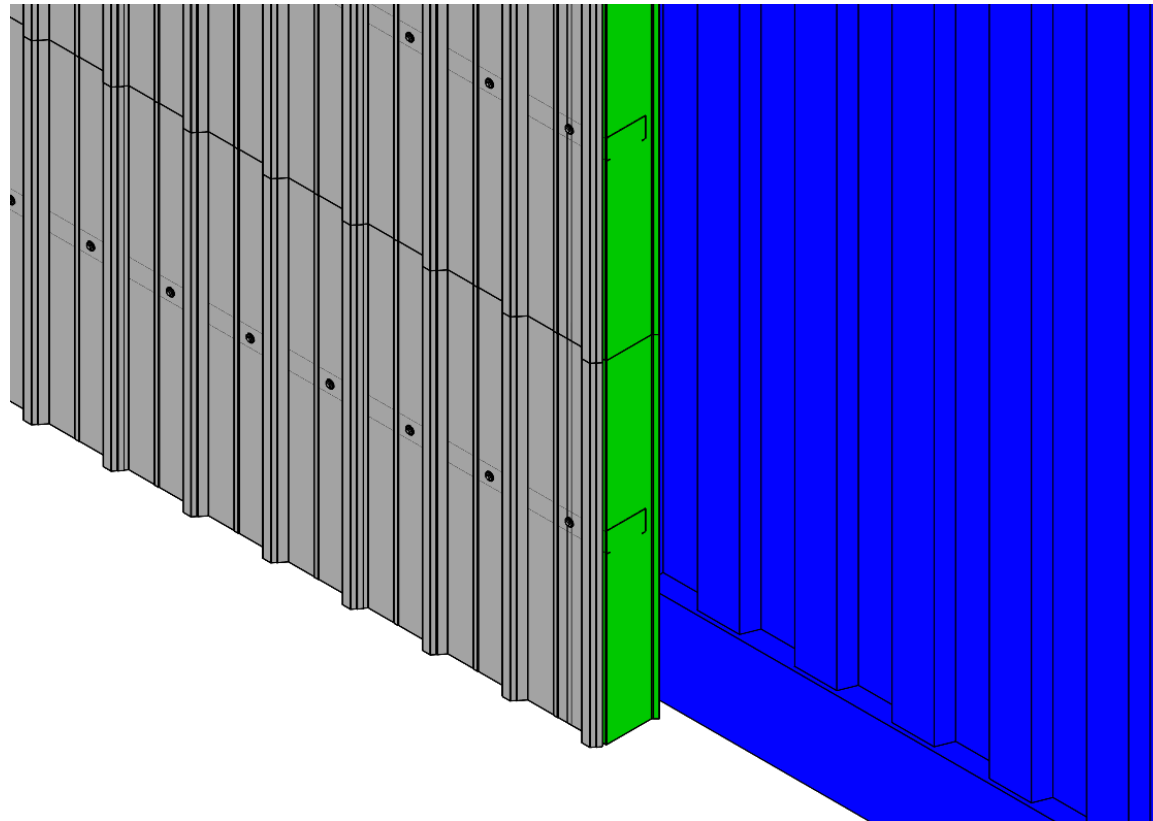

Assembly manual for workbox closed end wall trims

Montageanleitung für geschlossene Stirnwandverkleidungen der Workbox

Manuel d'assemblage pour les garnitures murales à extrémité fermée de la boîte de travail

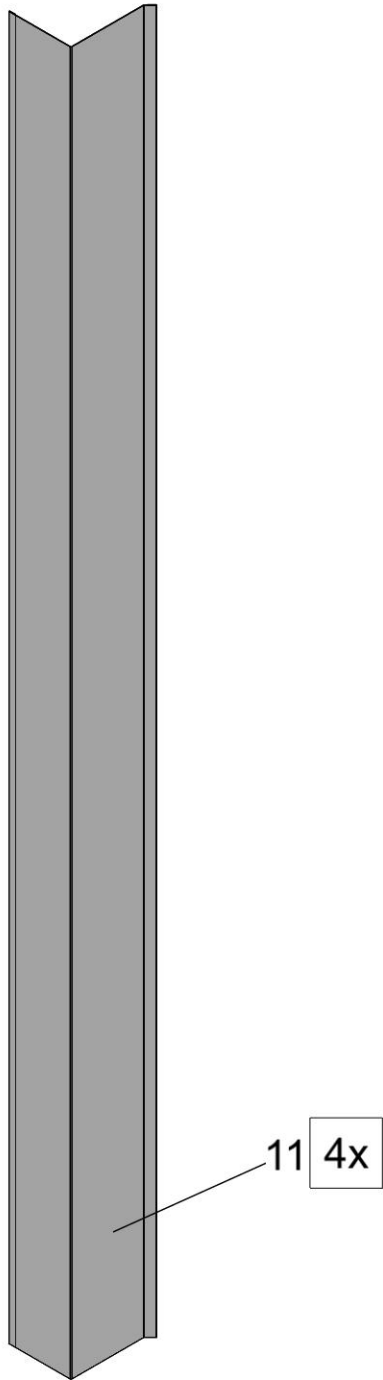



 Delivered with the sheeting crate  
 Wird mit der Folienkiste geliefert  
 Livré avec la caisse de bâche

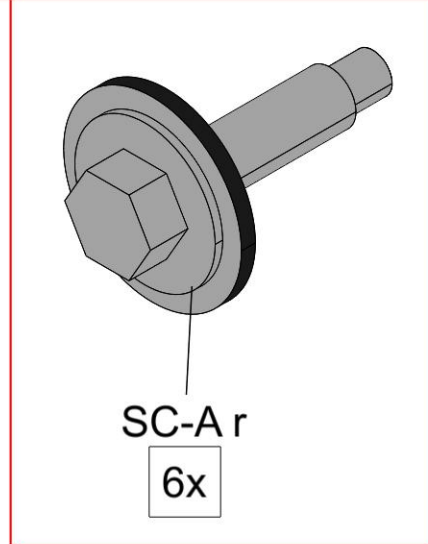

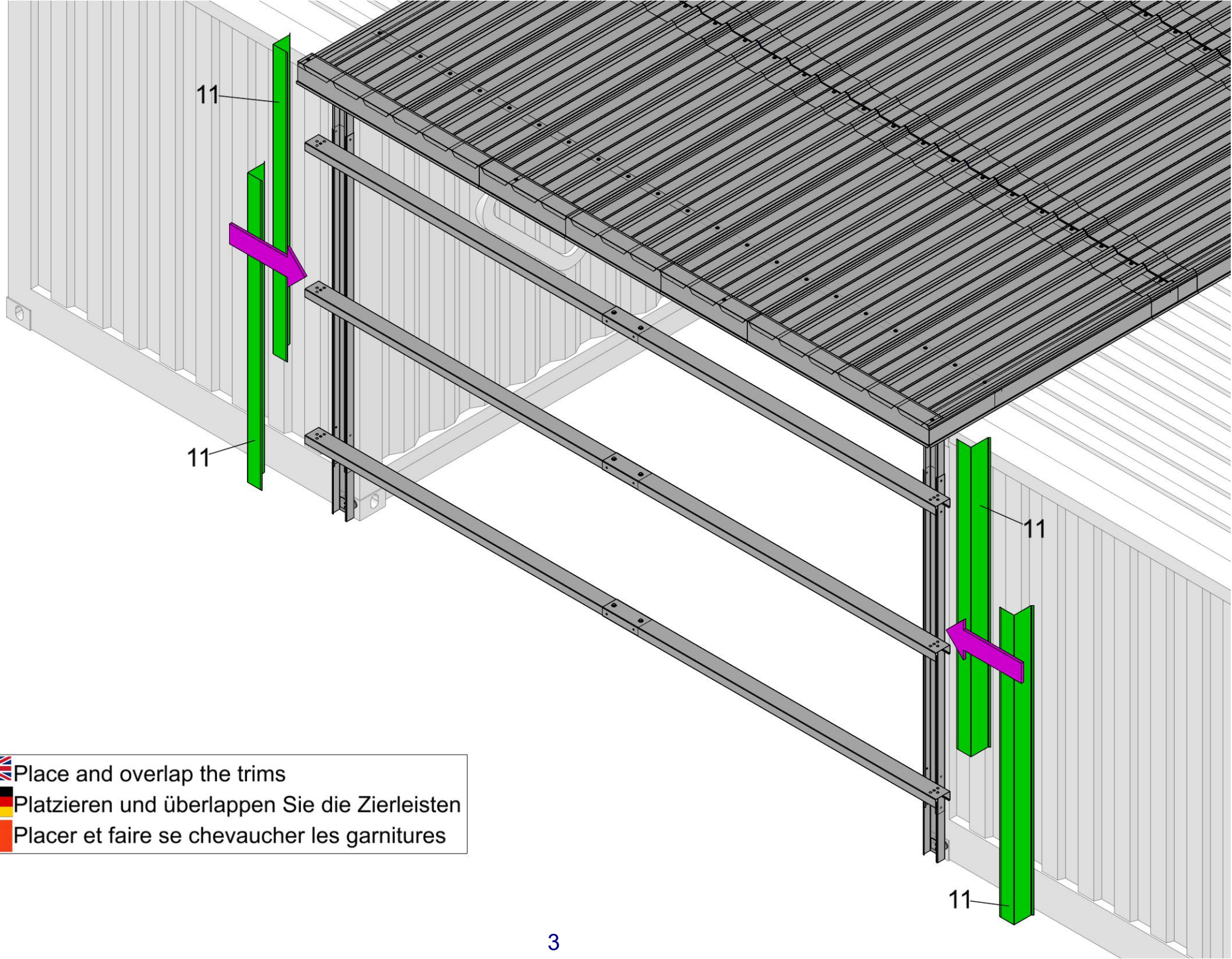

Place and overlap the trims



Platzieren und überlappen Sie die Zierleisten



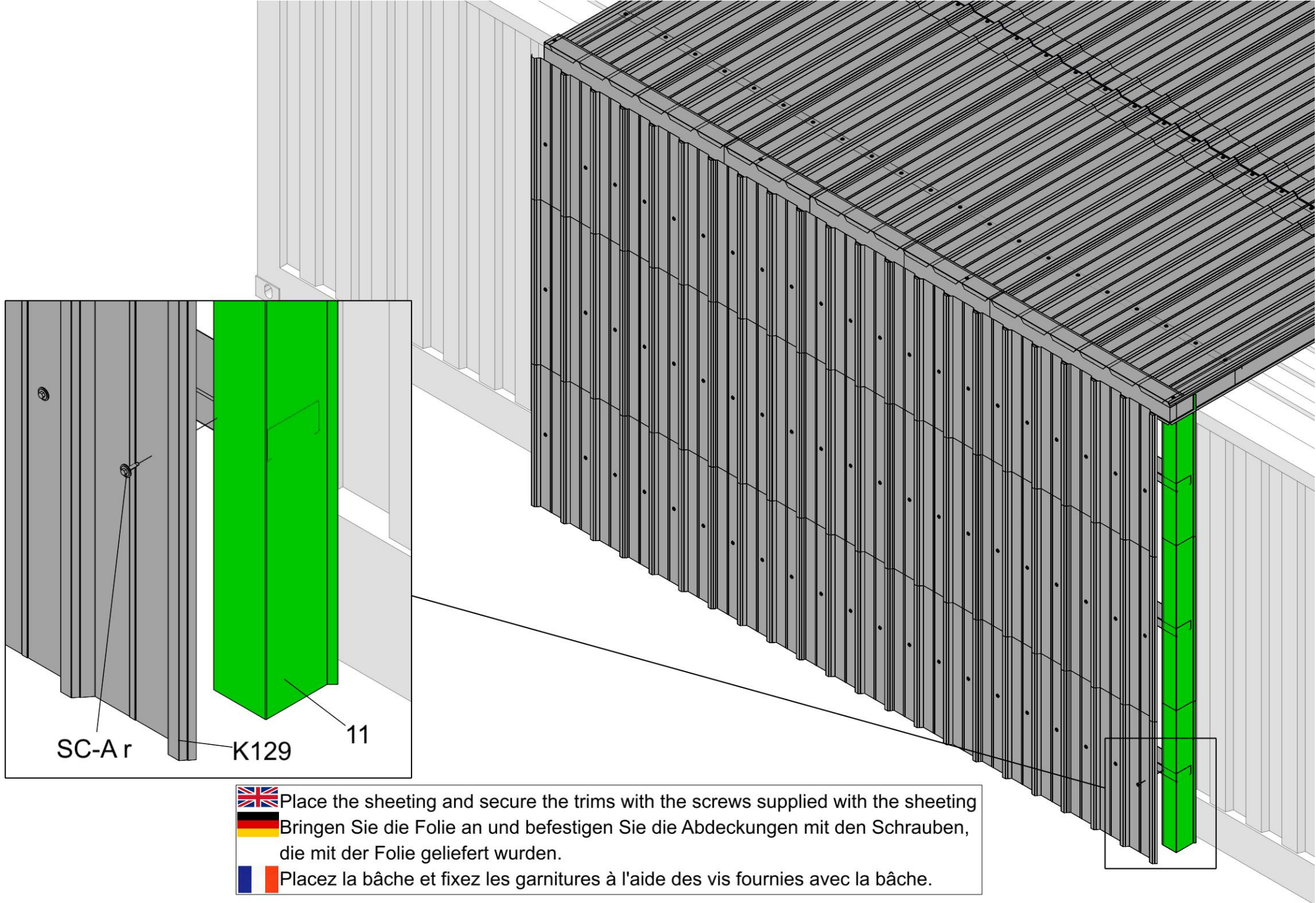

Placer et faire se chevaucher les garnitures



SC-A r

K129

11

 Place the sheeting and secure the trims with the screws supplied with the sheeting  
 Bringen Sie die Folie an und befestigen Sie die Abdeckungen mit den Schrauben, die mit der Folie geliefert wurden.  
 Placez la bâche et fixez les garnitures à l'aide des vis fournies avec la bâche.