

Container shelter/ Containerüberdachung / Abris sur containers

KROFTMAN CT-A-1206

Assembly manual for main frame
Montageanleitung für den Hauptrahmen
Manuel d'assemblage du cadre principal

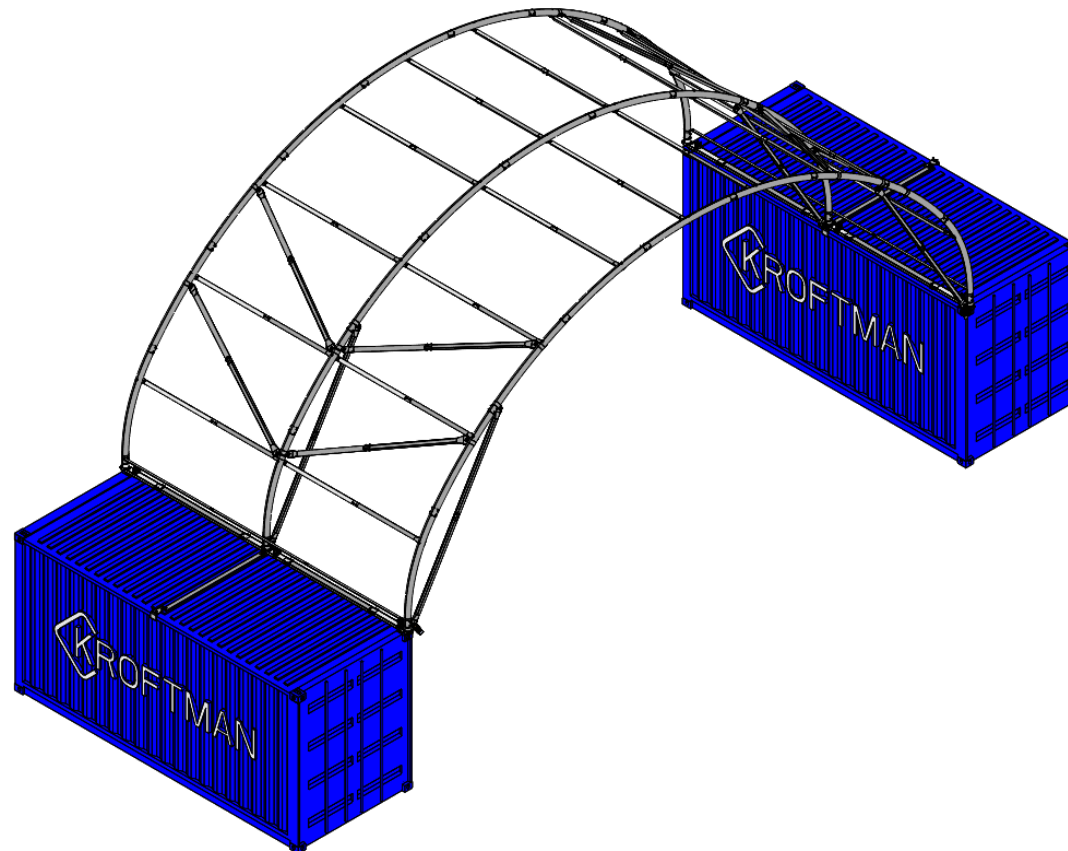

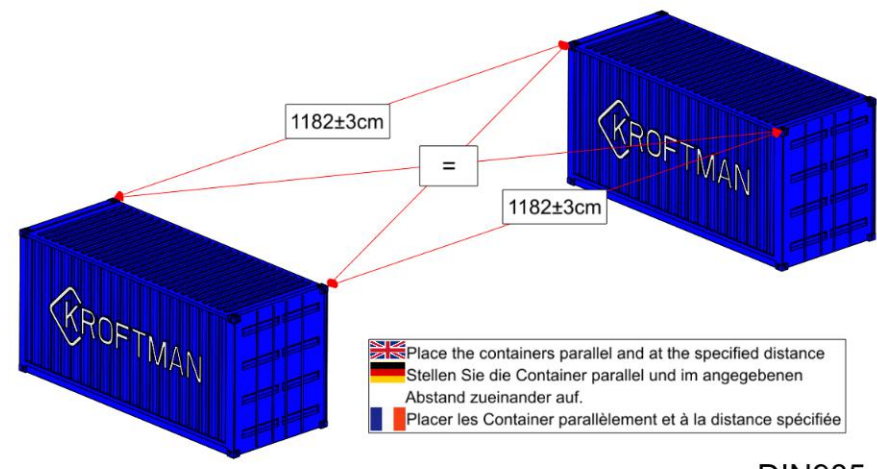
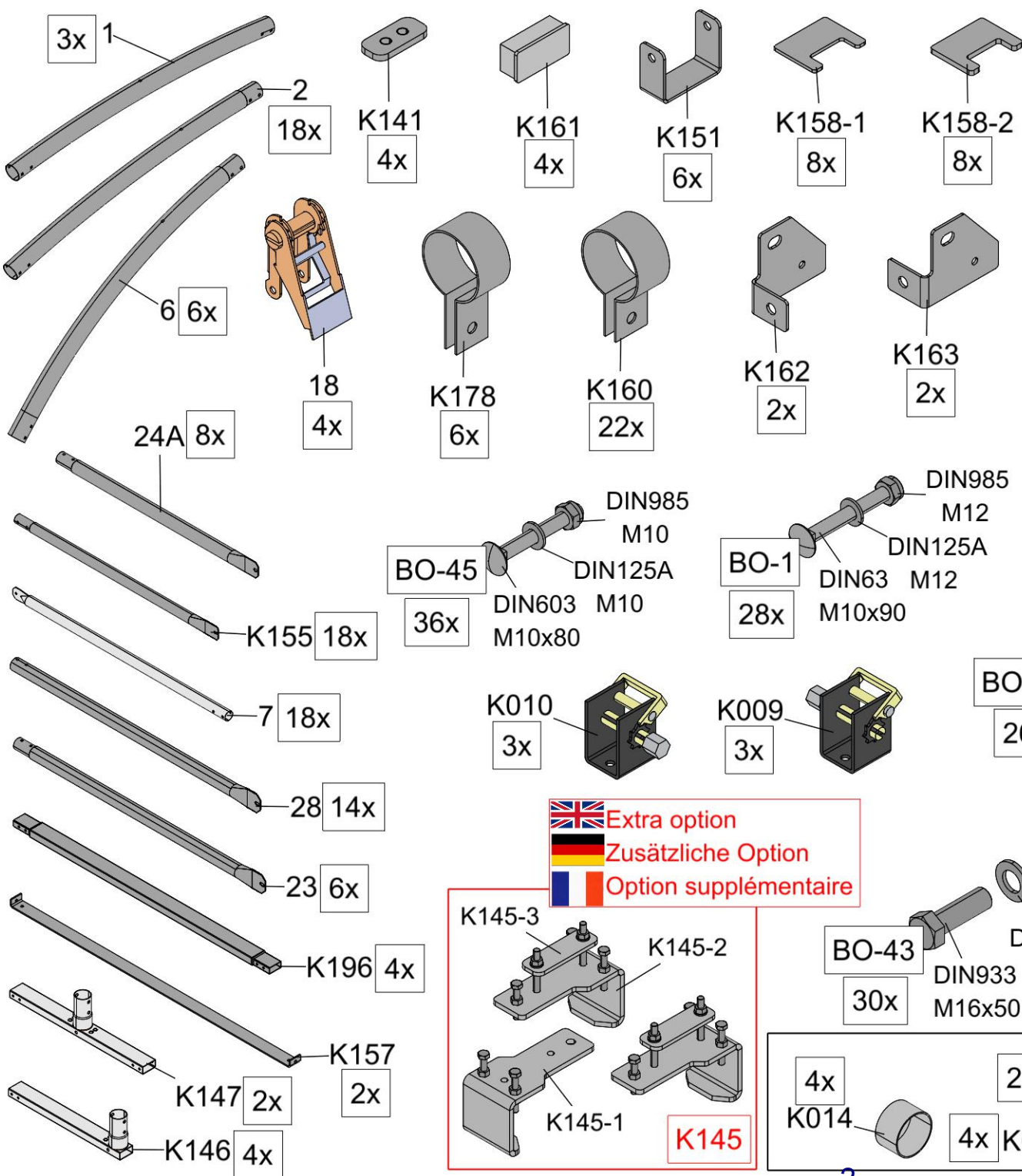

🇬🇧 Place the containers parallel and at the specified distance
 🇩🇪 Stellen Sie die Container parallel und im angegebenen Abstand zueinander auf.
 🇫🇷 Placer les Container parallèlement et à la distance spécifiée

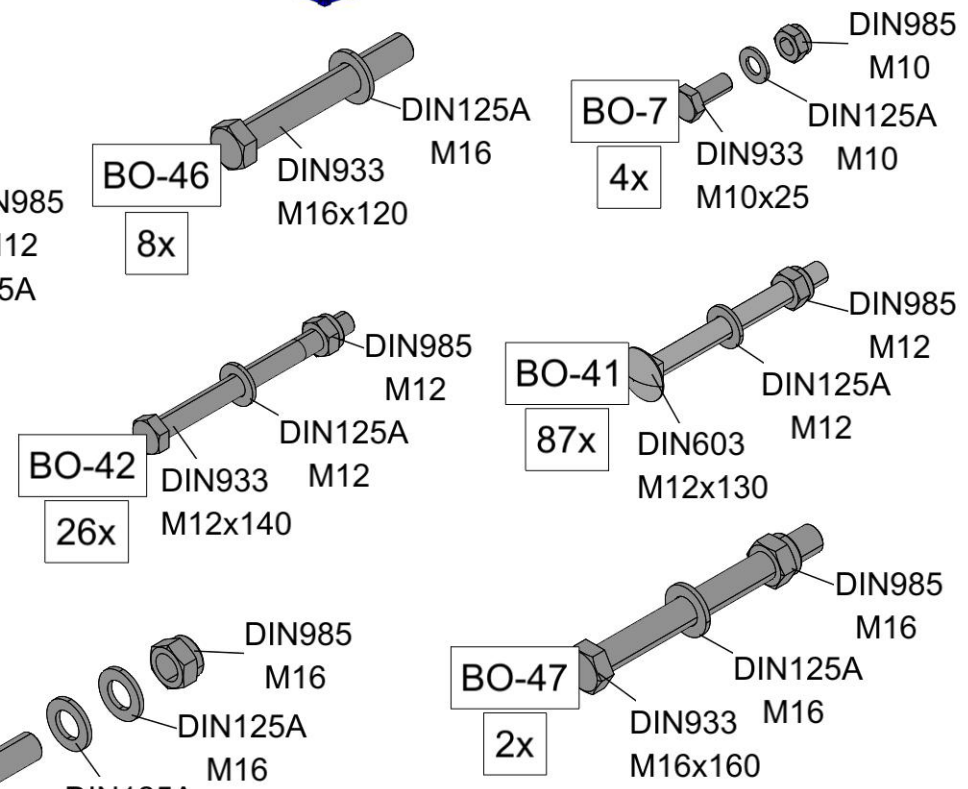



🇬🇧 Extra option
 🇩🇪 Zusätzliche Option
 🇫🇷 Option supplémentaire

🇬🇧 Needed for cover assembly
 🇩🇪 Erforderlich für die Montage der Abdeckung
 🇫🇷 Nécessaire pour l'assemblage du couvercle

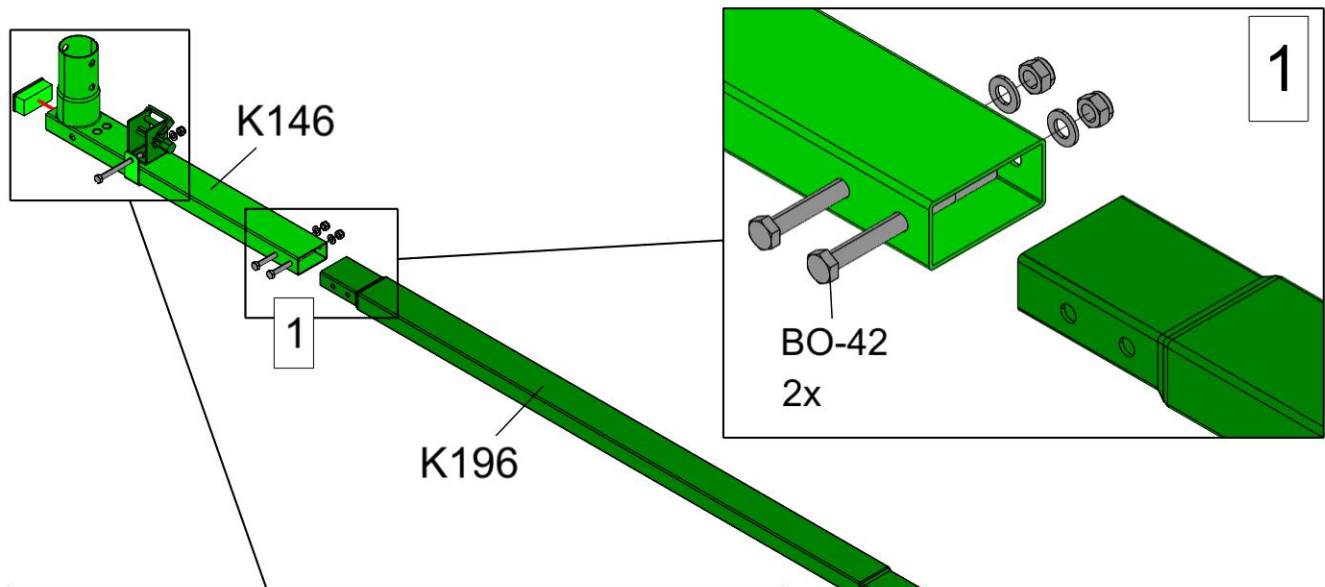



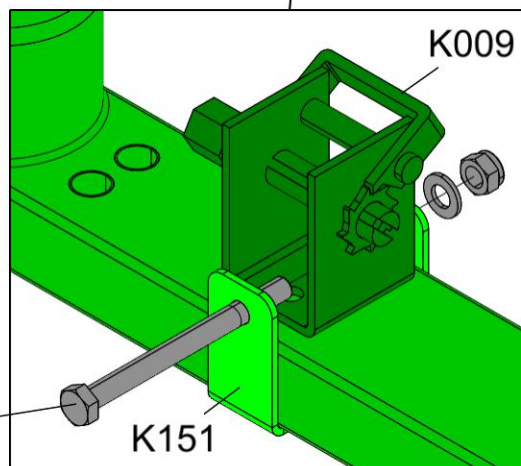
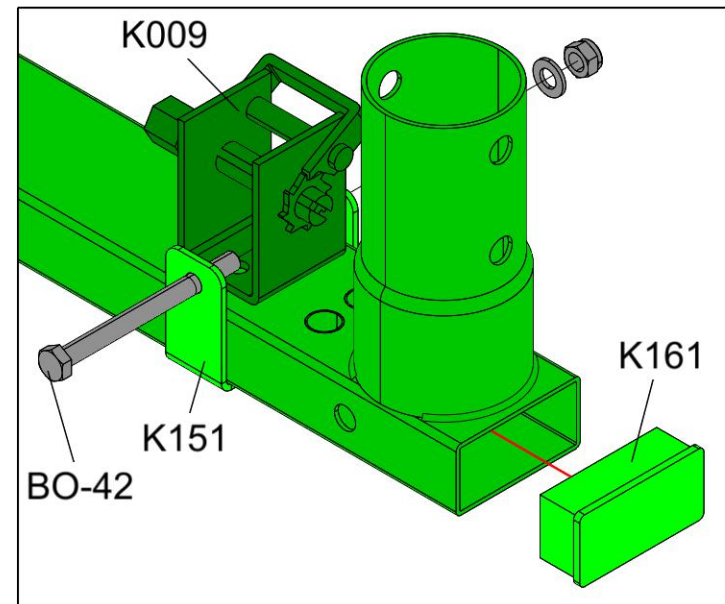
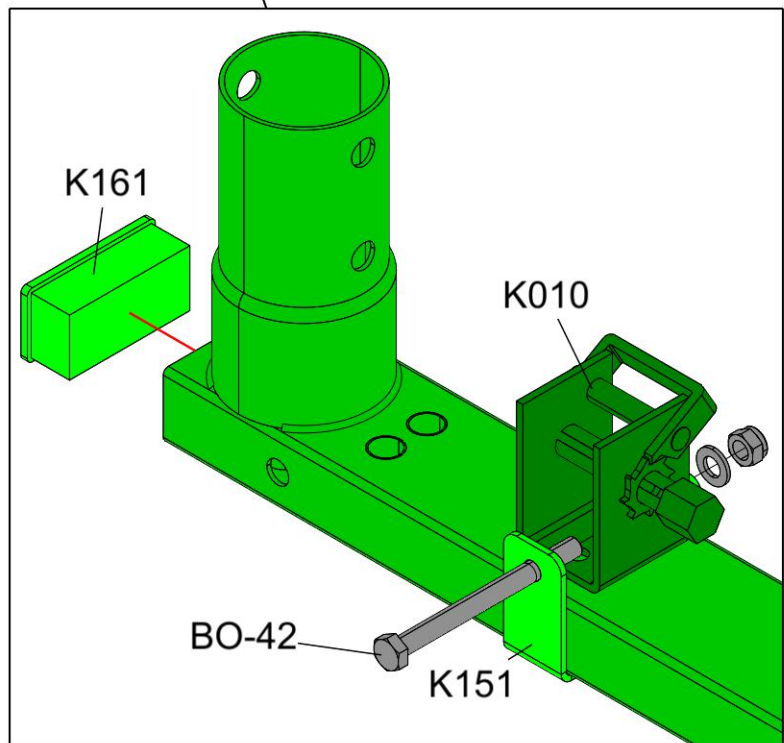

 The right side base rail is mirrored
 Die rechte Grundschiene ist gespiegelt
 Le rail de la base droite est en miroir

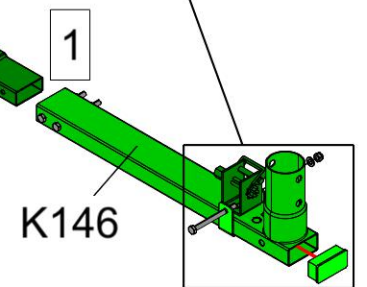

 Left side
 Linke Seite
 Côté gauche





 Install the plate and secure everything by tightening the nuts hand-tight.

 Montieren Sie die Platte an und sichern Sie alles, indem Sie die Muttern handfest anziehen.

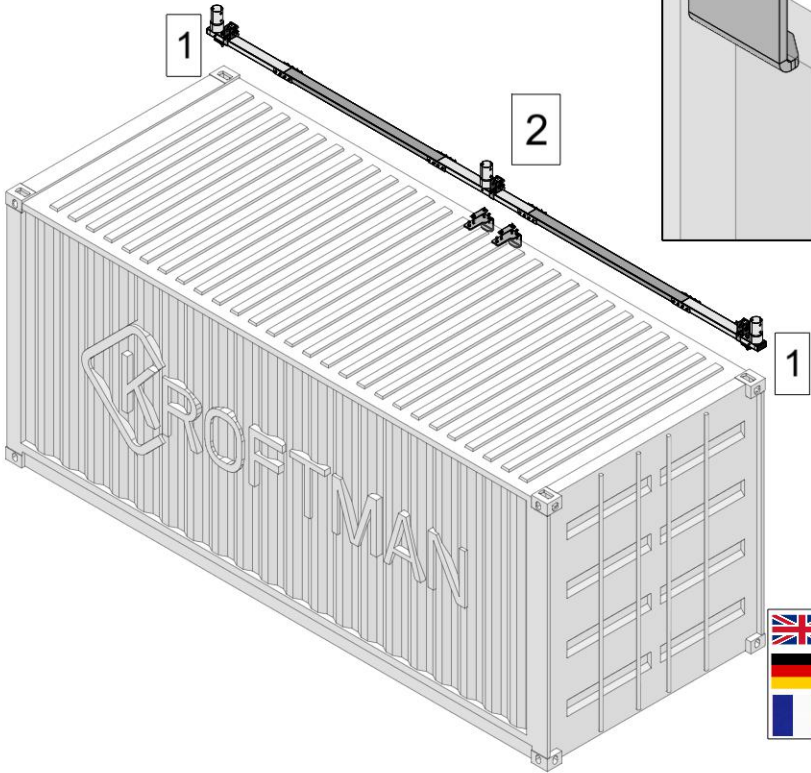
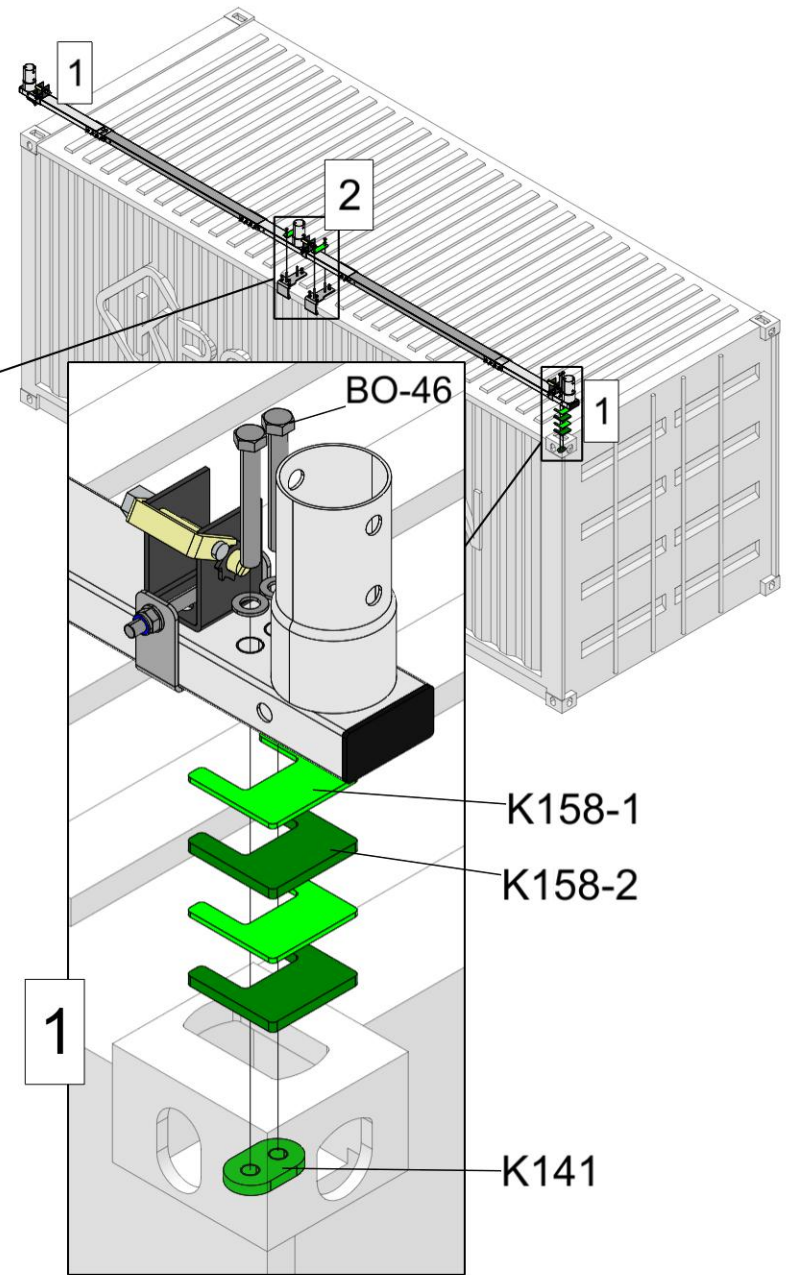
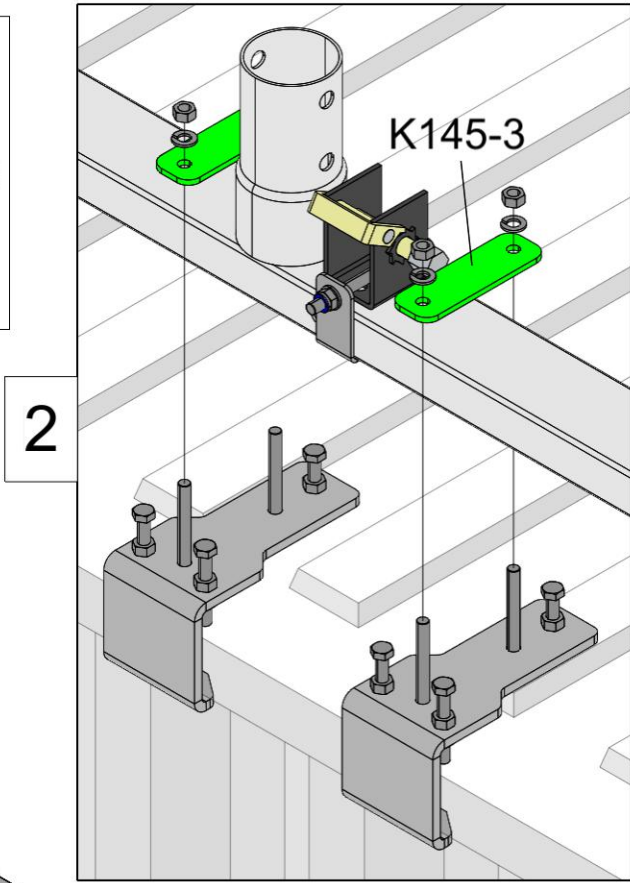
 Installez la plaque et fixez le tout en serrant les écrous à la main.



 On the corners of the container use a combination of plates that fits best.

 Verwenden Sie an den Ecken des Containers eine Kombination von Platten, die am besten passt.

 Sur les coins du conteneur, utilisez une combinaison de plaques qui convient le mieux.

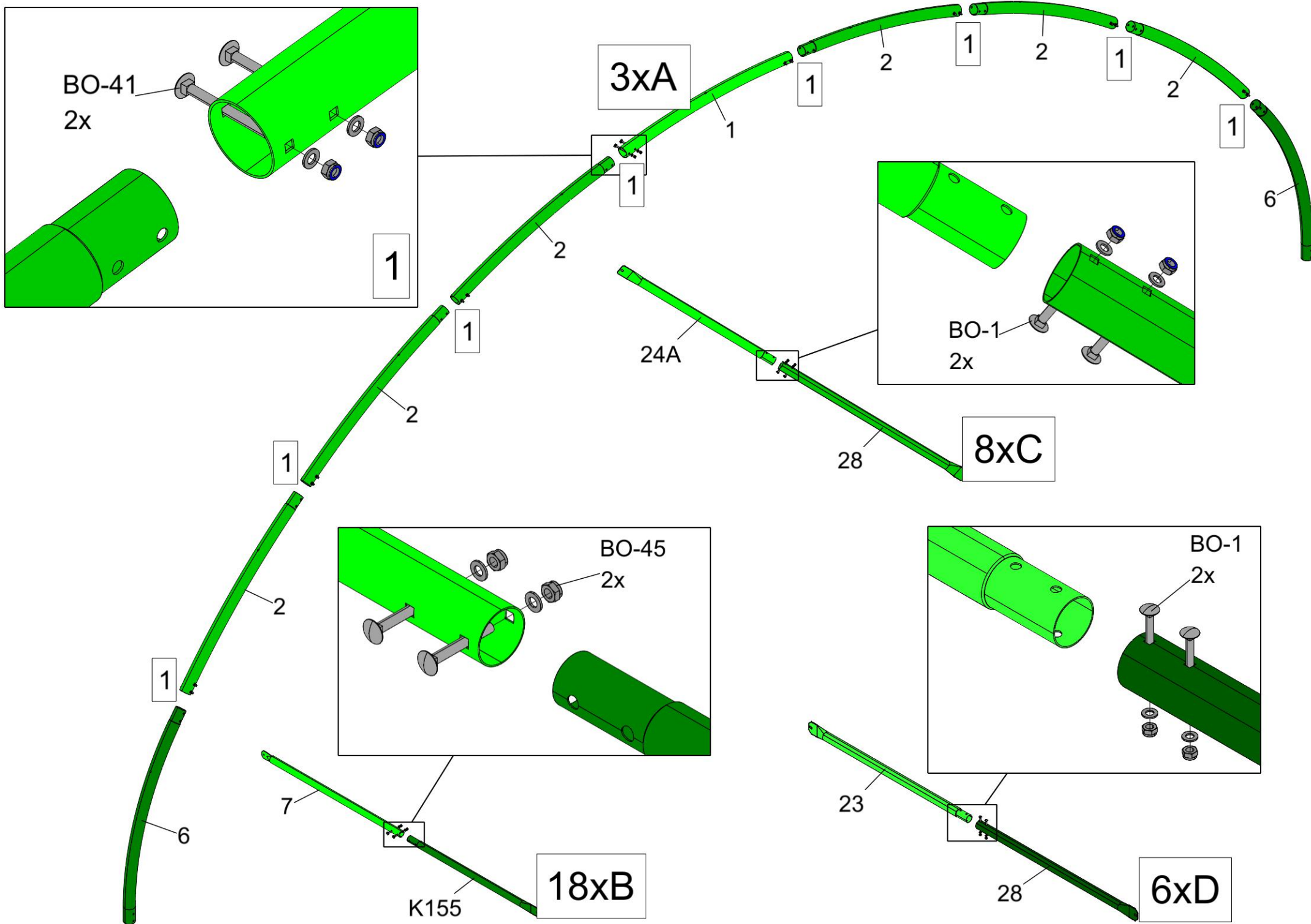

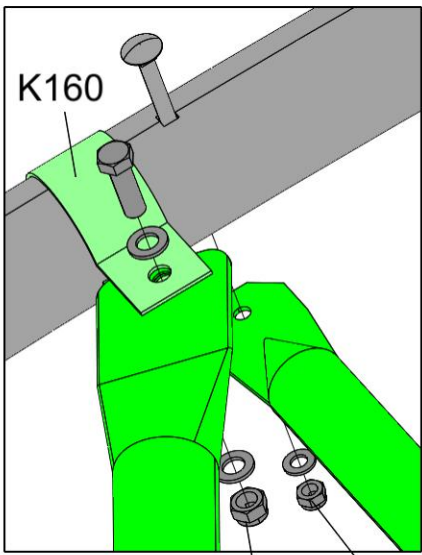

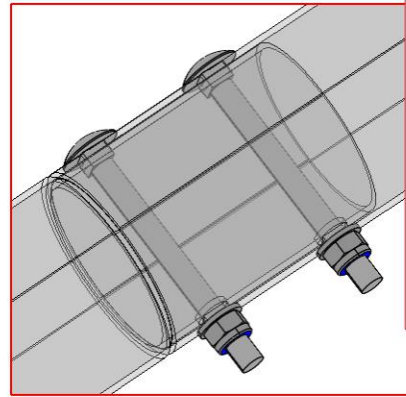

BO-43 BO-41



 When placing the first and last arch make sure the boltheads point outwards

 Achten Sie beim Anbringen des ersten und letzten Bogens darauf, dass der Schraubenkopf nach außen zeigt.

 Lorsque vous placez le premier et le dernier arc, veillez à ce que la tête de boulon soit orientée vers l'extérieur.

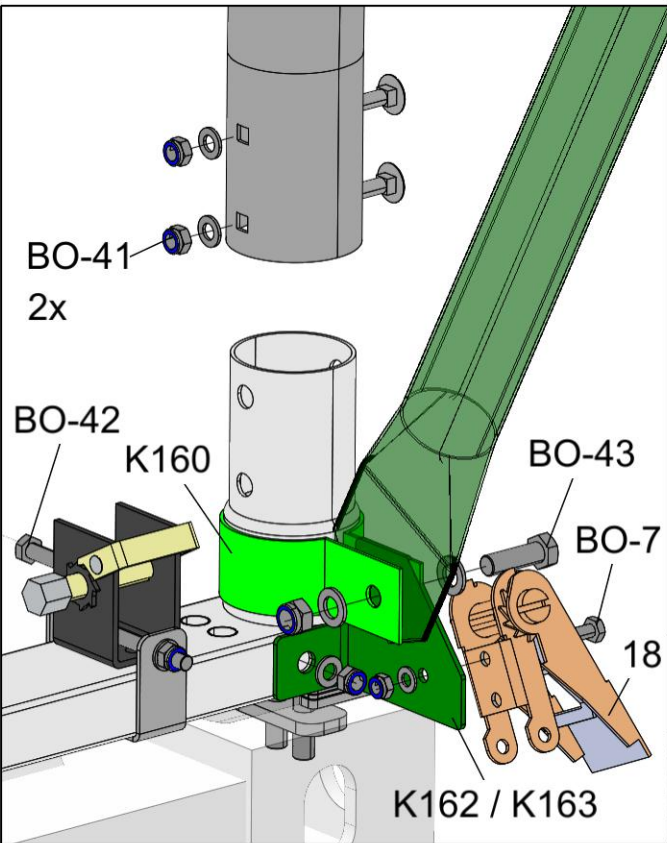

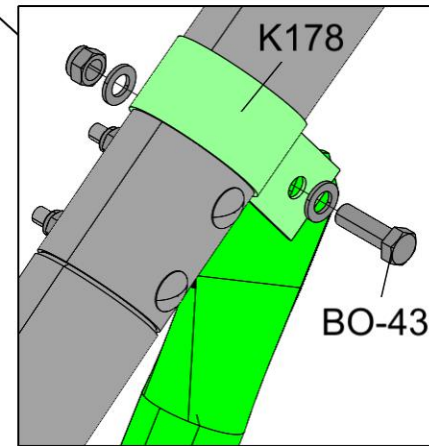

K162 / K163

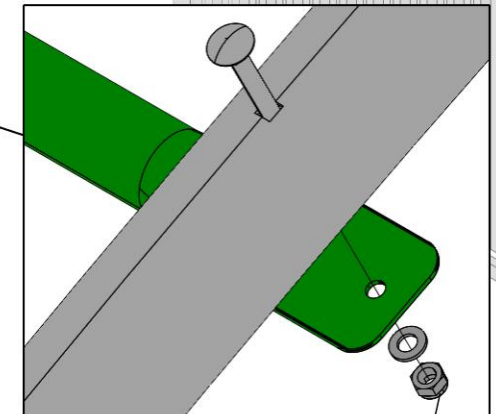

BO-43



BO-41

 Important: add permanent weight in containers according to calculations or use optional container anchoring bracket.
 Wichtig: Fügen Sie den Containern ein dauerhaftes Gewicht gemäß den Berechnungen hinzu oder verwenden Sie die optionalen Container- Verankerungsklammern.
 Important : ajoutez le poids permanent dans les conteneurs selon les calculs ou utilisez le support d'ancrage de conteneur en option.

