

KROFTMAN WB-400 / WB-600

Assembly manual for workbox closed end wall trims

Montageanleitung für geschlossene Stirnwandverkleidungen der Workbox

Manuel d'assemblage pour les garnitures murales à extrémité fermée de la boîte de travail

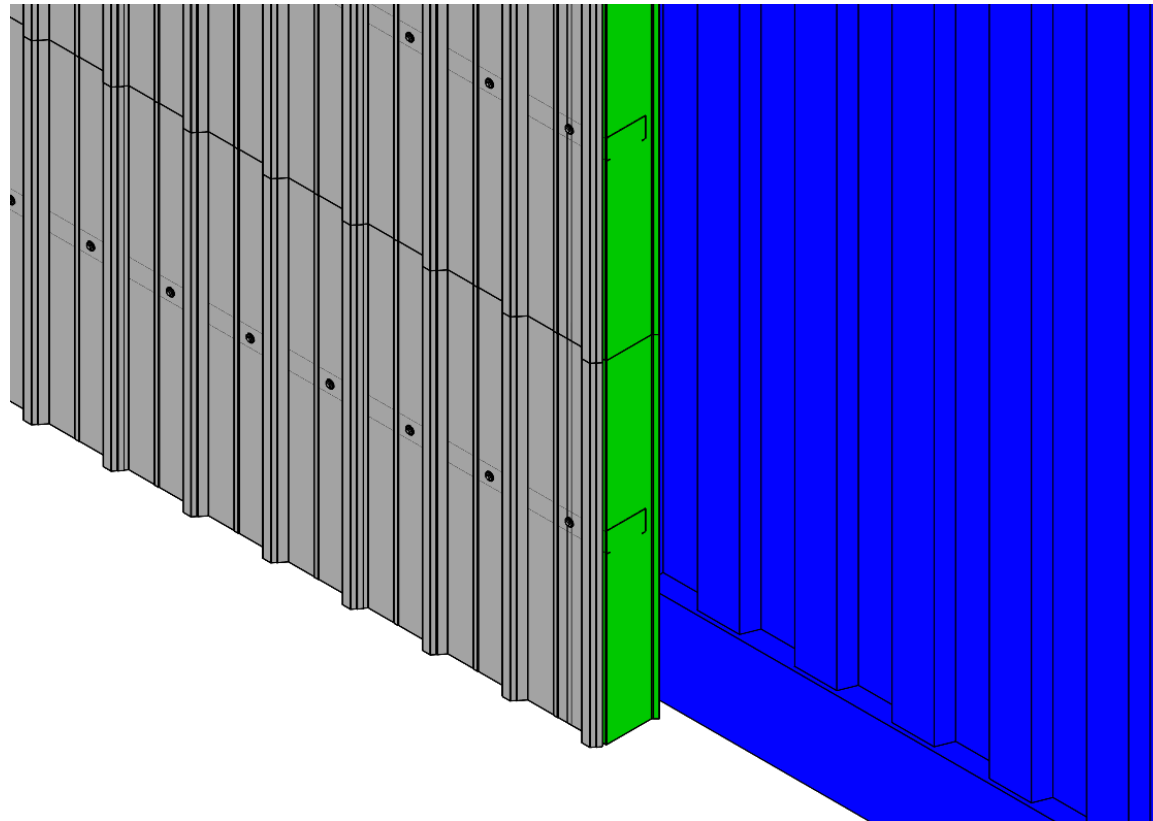

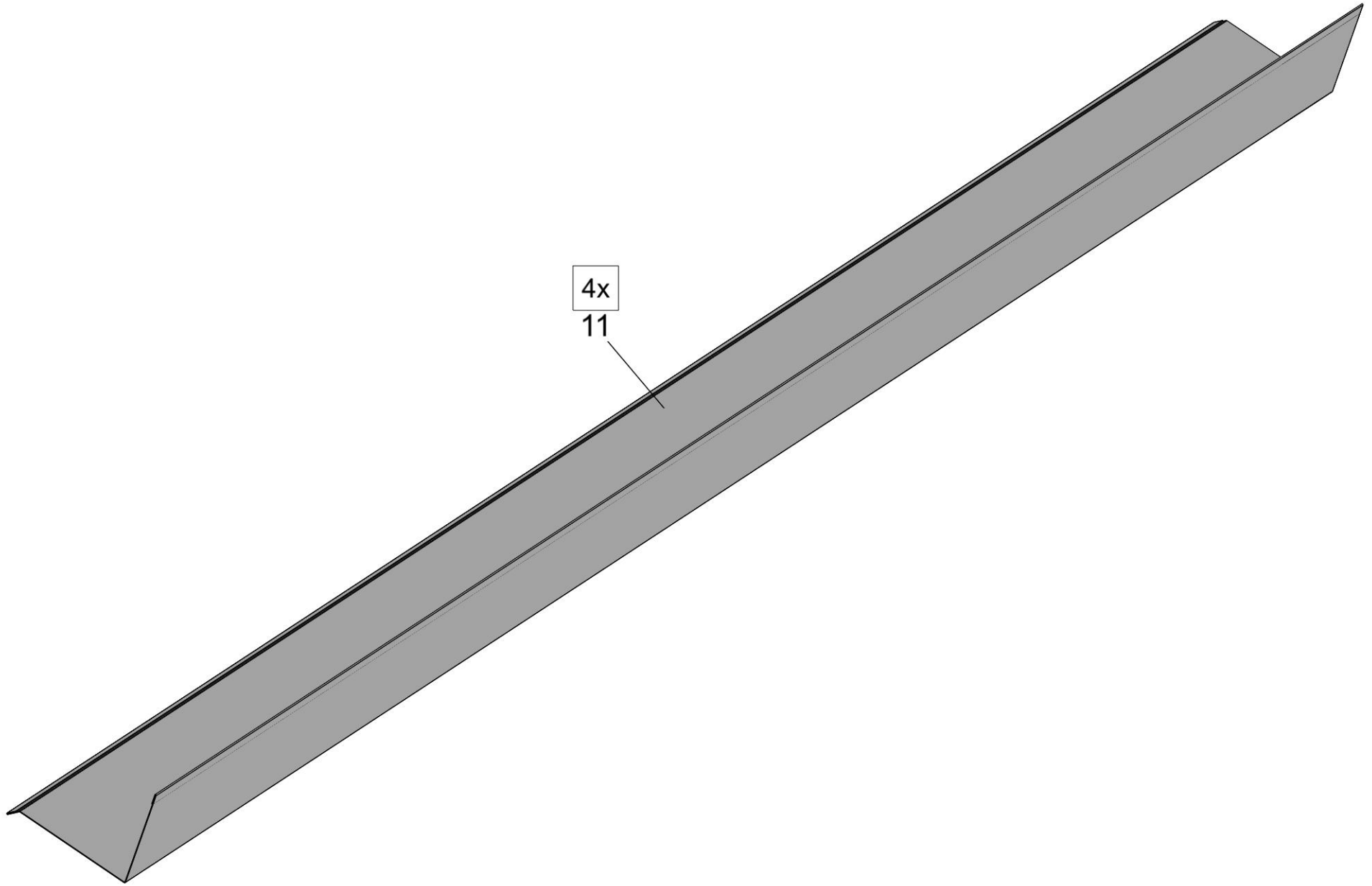

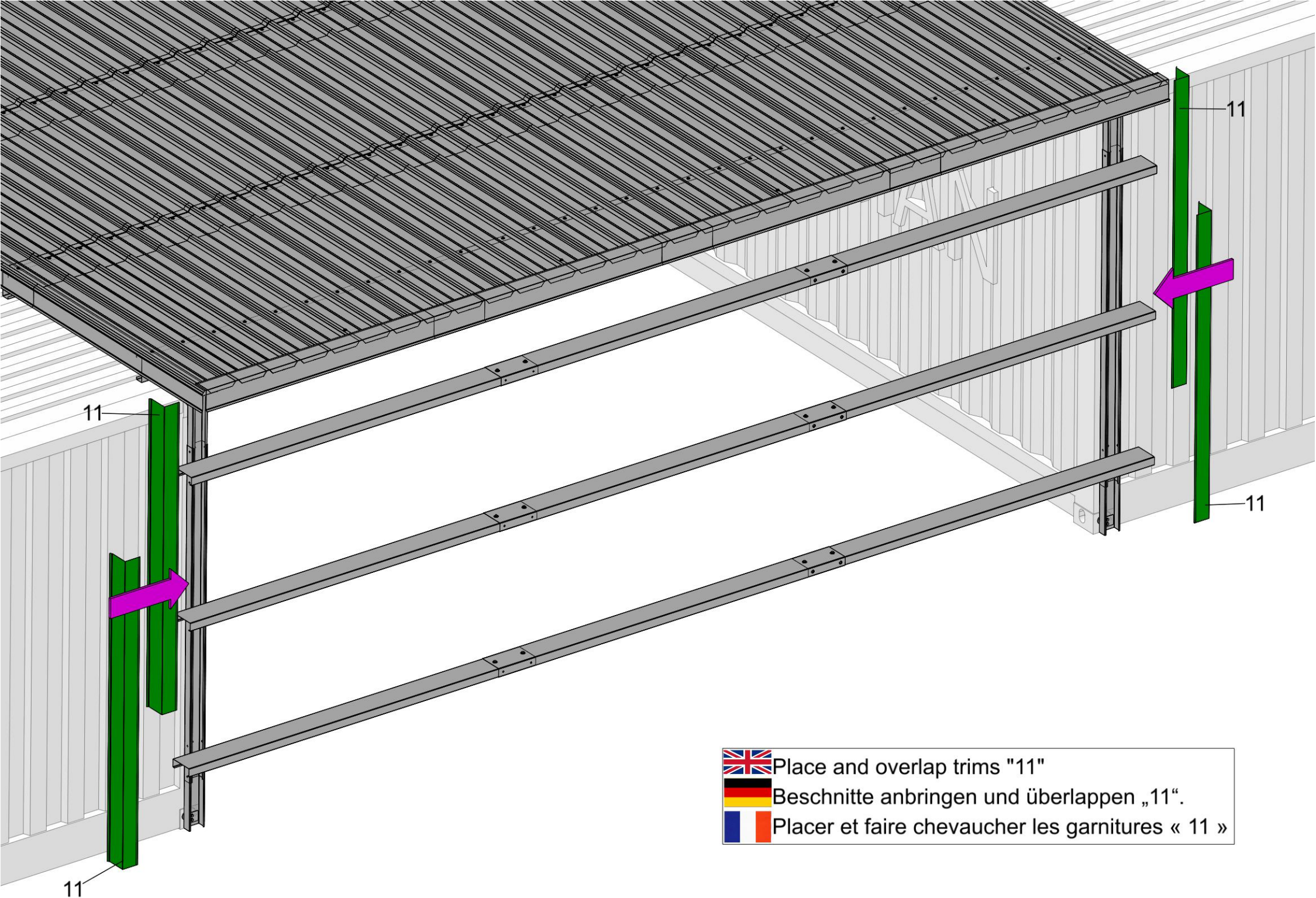

Place and overlap trims "11"



Beschnitte anbringen und überlappen „11“.



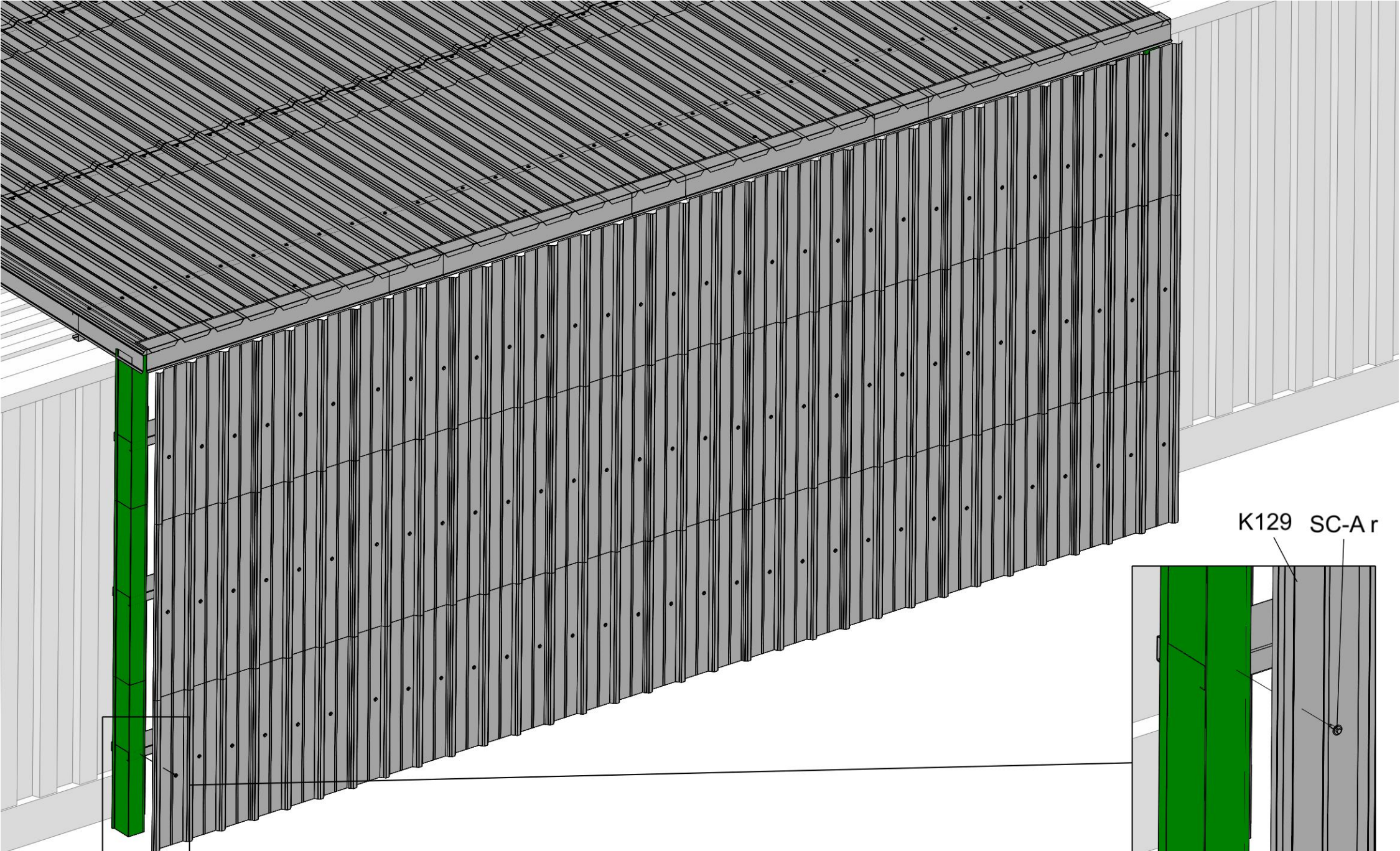

Placer et faire chevaucher les garnitures « 11 »

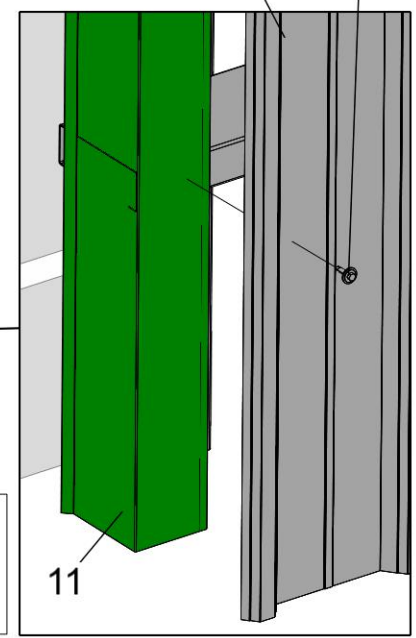

K129 SC-A r



-  Place the sheeting and secure the trims with the sheeting's screws
-  Bringen Sie die Verkleidung an und befestigen Sie die Abdeckungen mit den Schrauben der Verkleidung.
-  Placez la bâche et fixez les garnitures avec les vis de la bâche.