

# KROFTMAN CT-A-1006-HD-V25 Concrete Wall

Assembly manual for main frame  
Montageanleitung für den Hauptrahmen  
Manuel d'assemblage du cadre principal

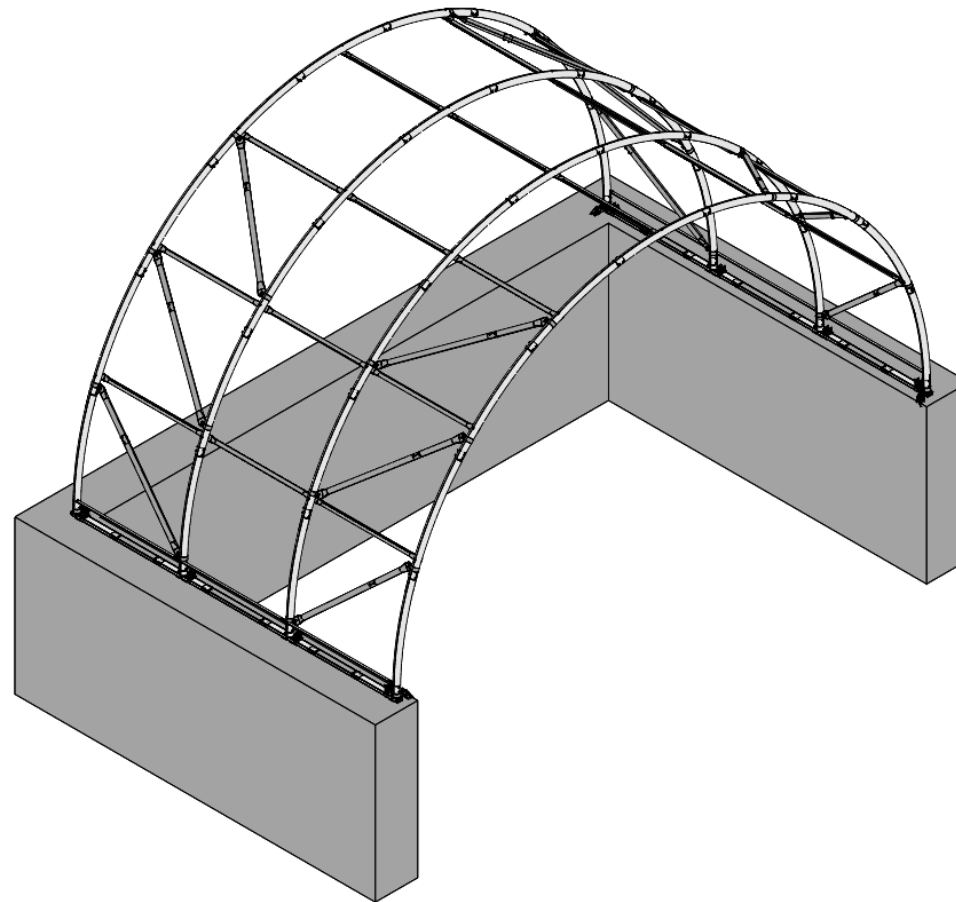

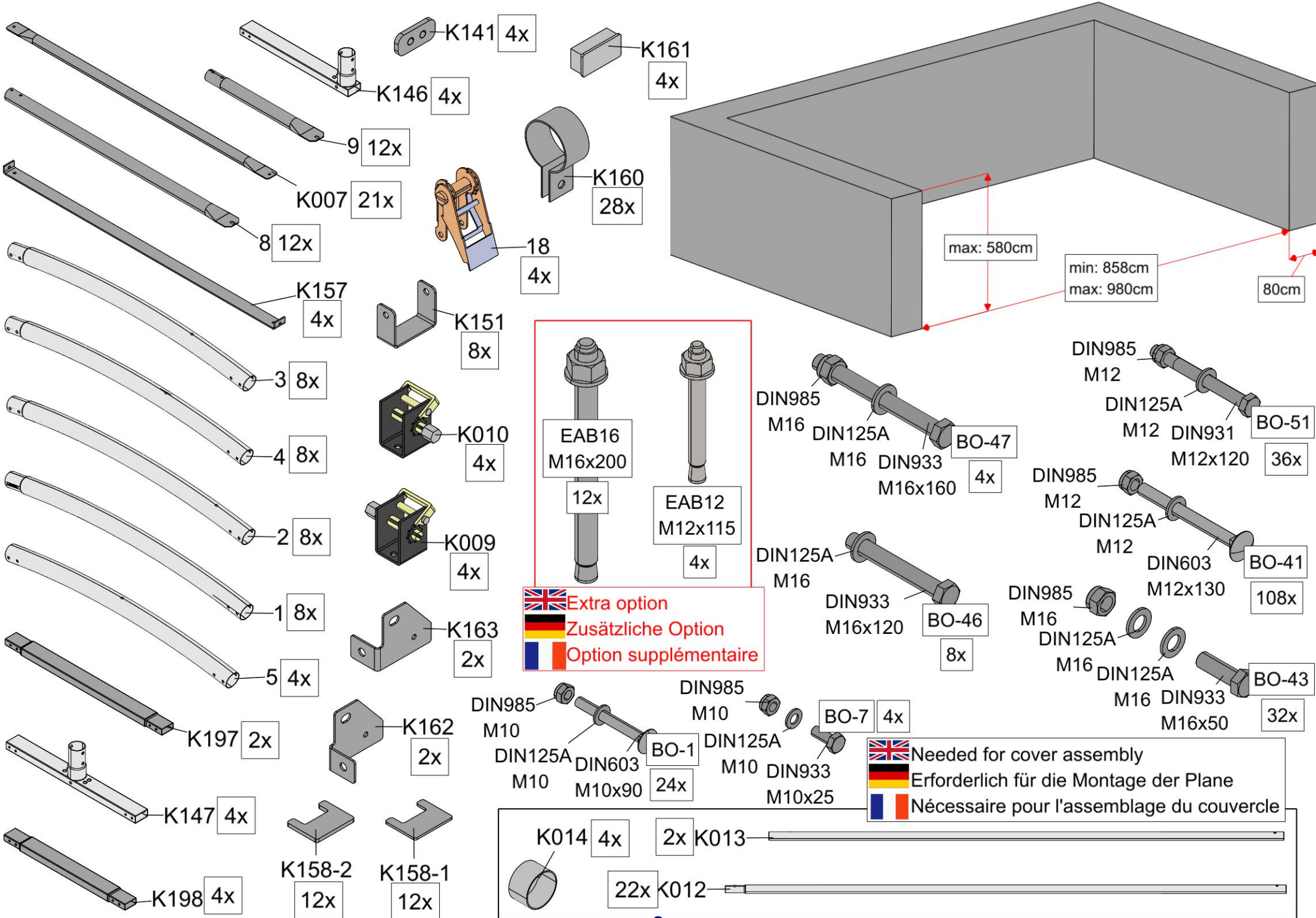



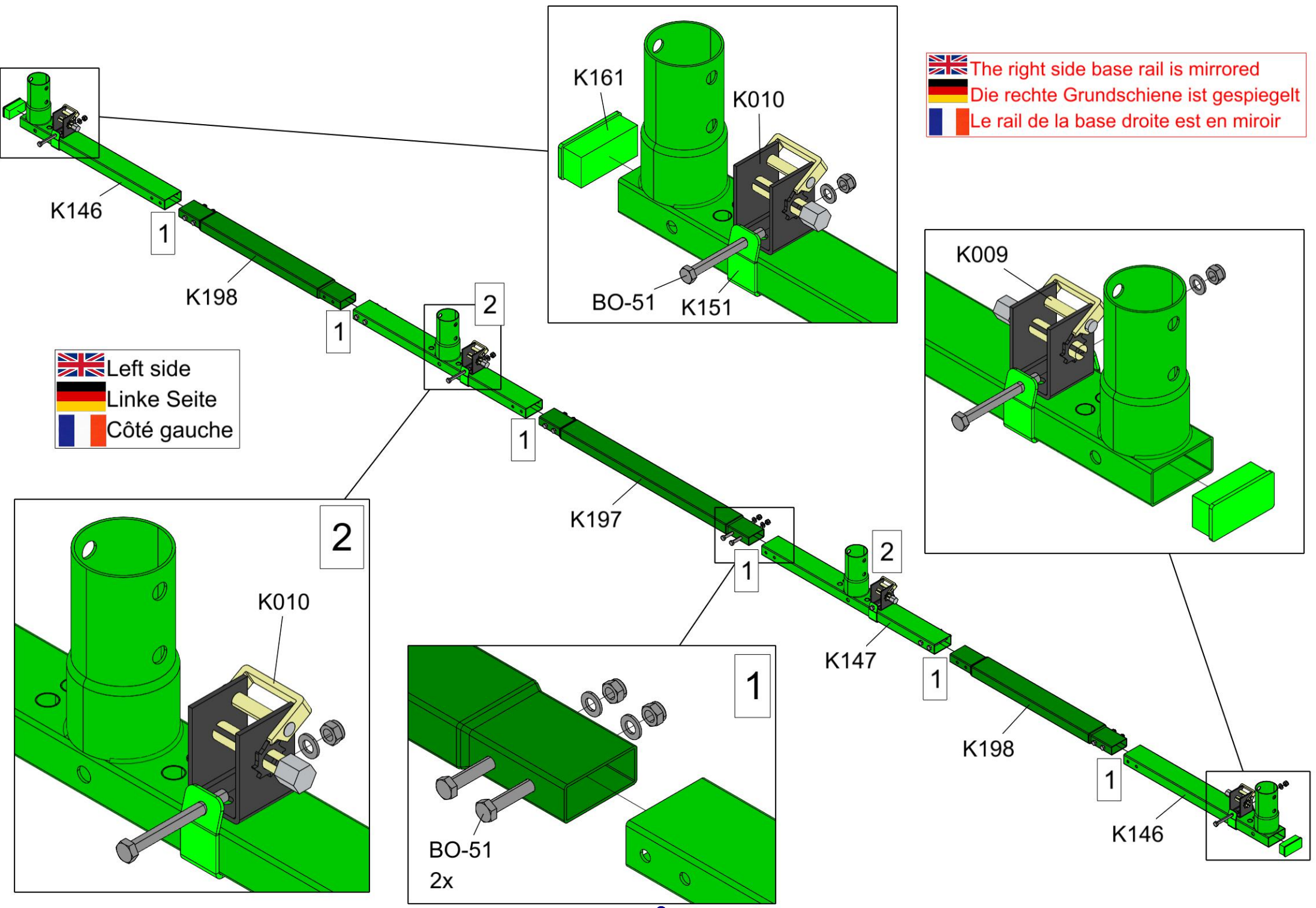

 The right side base rail is mirrored  
 Die rechte Grundschiene ist gespiegelt  
 Le rail de la base droite est en miroir

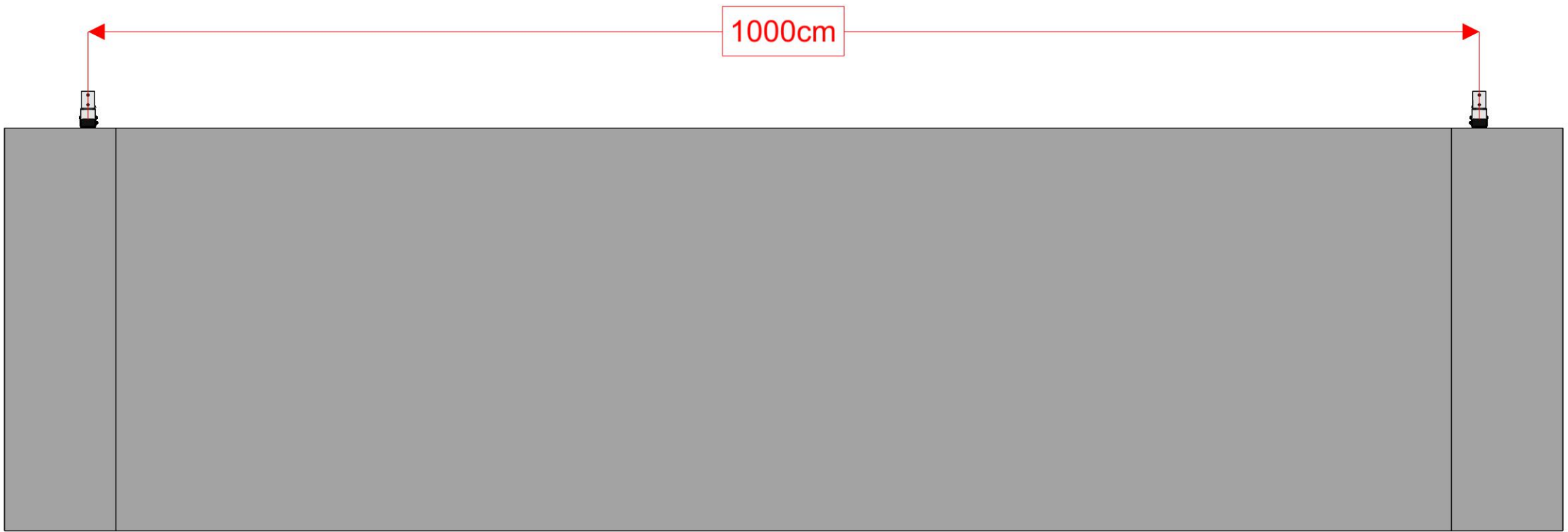
 Left side  
 Linke Seite  
 Côté gauche







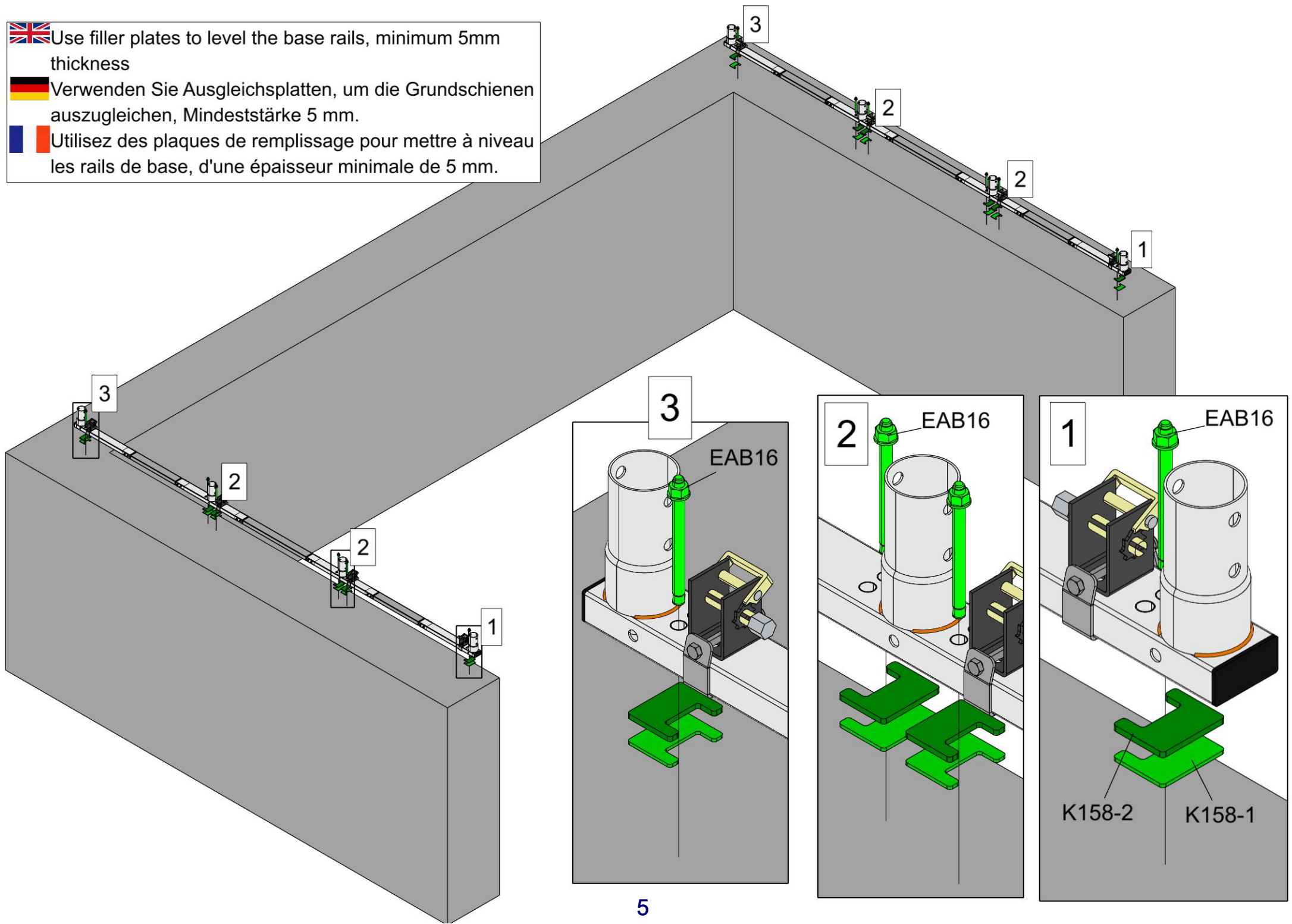

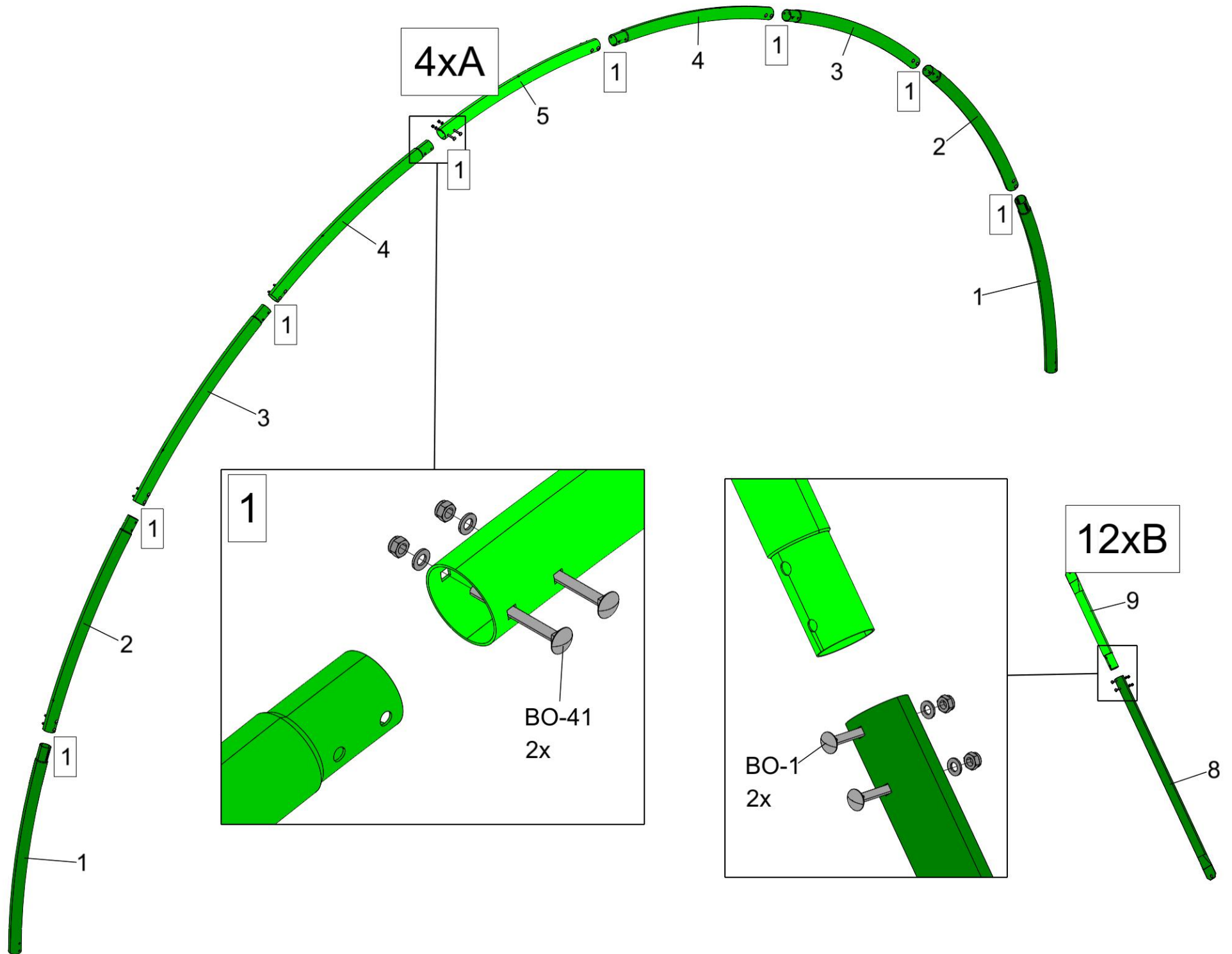

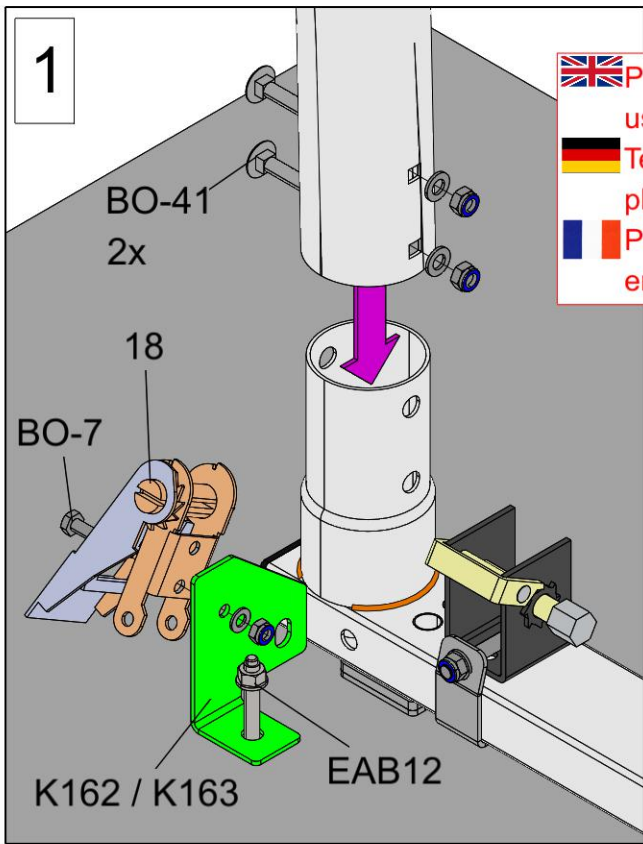
 Use filler plates to level the base rails, minimum 5mm thickness  
 Verwenden Sie Ausgleichsplatten, um die Grundschienen auszugleichen, Mindeststärke 5 mm.  
 Utilisez des plaques de remplissage pour mettre à niveau les rails de base, d'une épaisseur minimale de 5 mm.







-  Place "K162 / K163" part using only EAB12
-  Teil "K162 / K163" nur mit EAB12 platzieren
-  Placer la pièce "K162 / K163" en utilisant uniquement EAB12

-  When placing the first and last arch make sure the boltheads point outwards
-  Achten Sie beim Anbringen des ersten und letzten Bogens darauf, dass der Schraubenkopf nach außen zeigt.
-  Lorsque vous placez le premier et le dernier arc, veillez à ce que la tête de boulon soit orientée vers l'extérieur.

