

Container shelter/ Containerüberdachung / Abris sur containers

# KROFTMAN CT-A-H-1200

Assembly manual for half end wall frame

Montageanleitung für Halbstirnwandzargen

Manuel d'assemblage pour le cadre mural en demi-lune

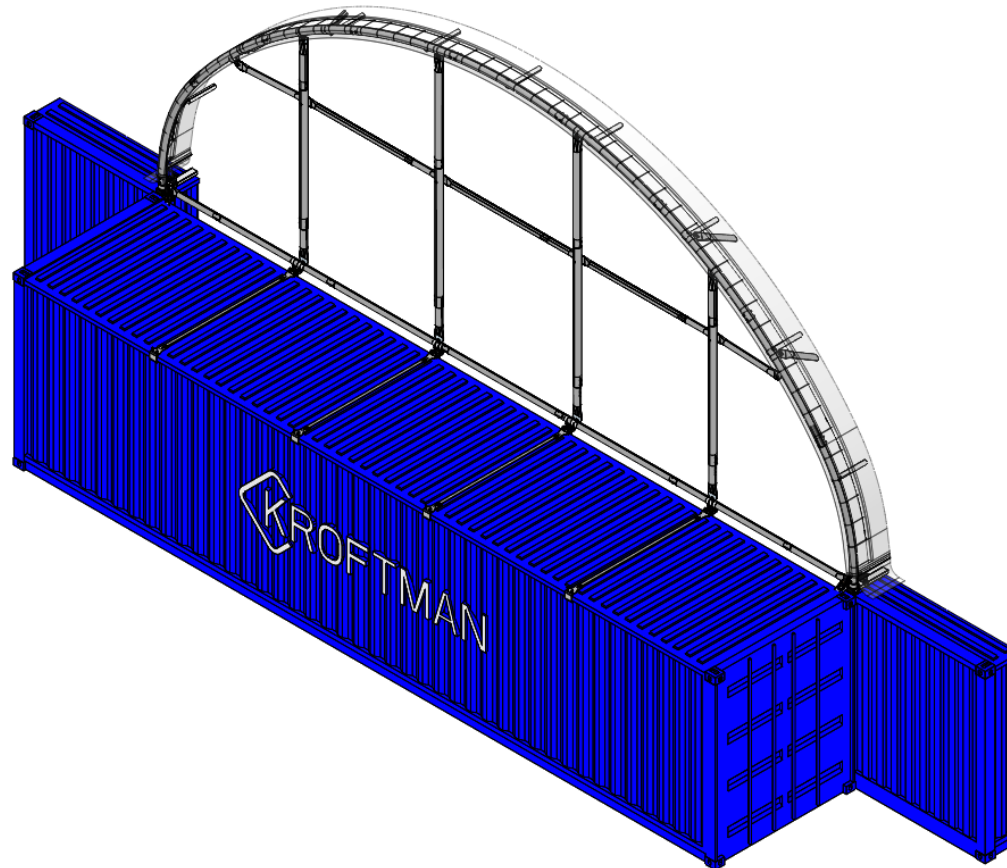

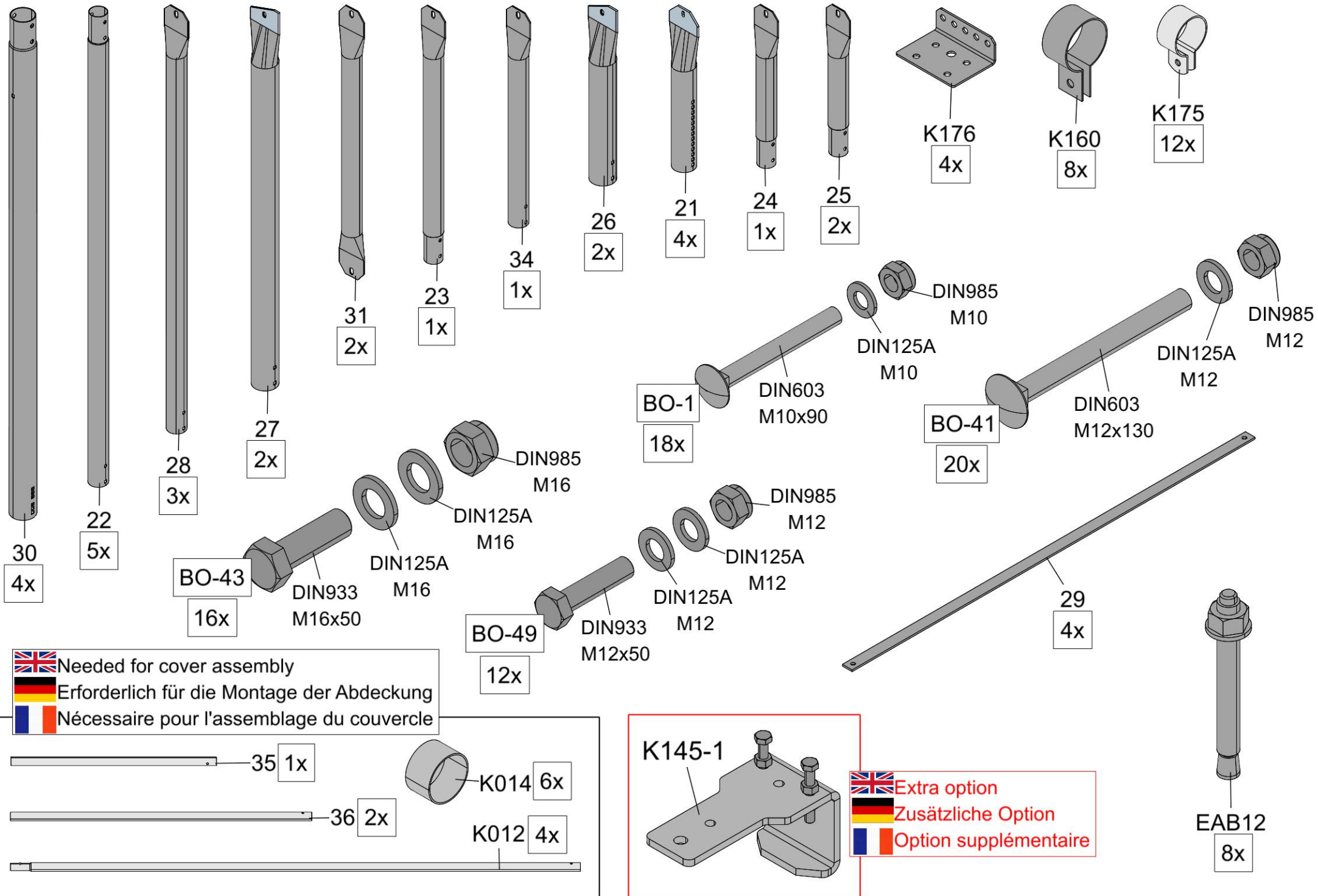

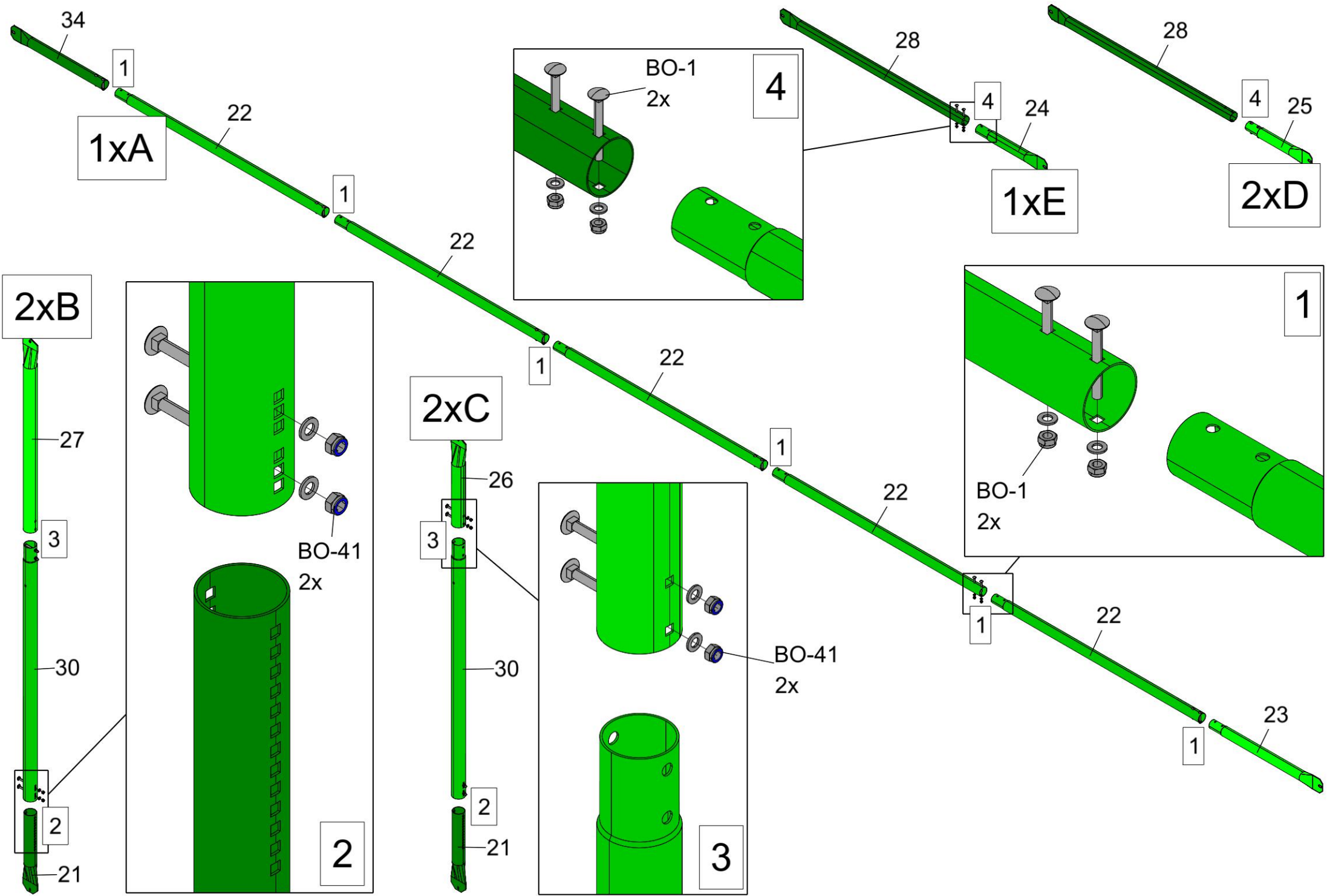

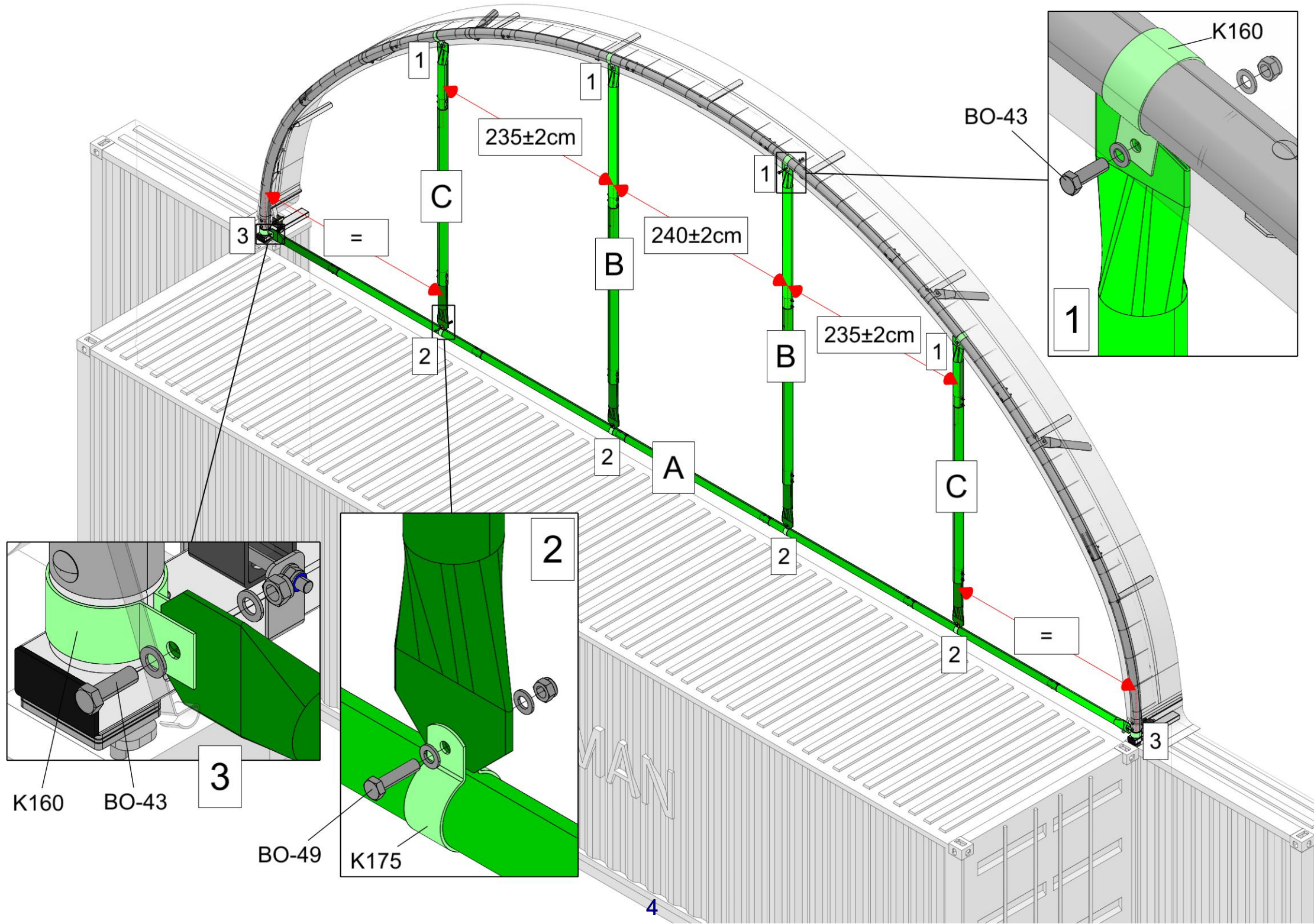

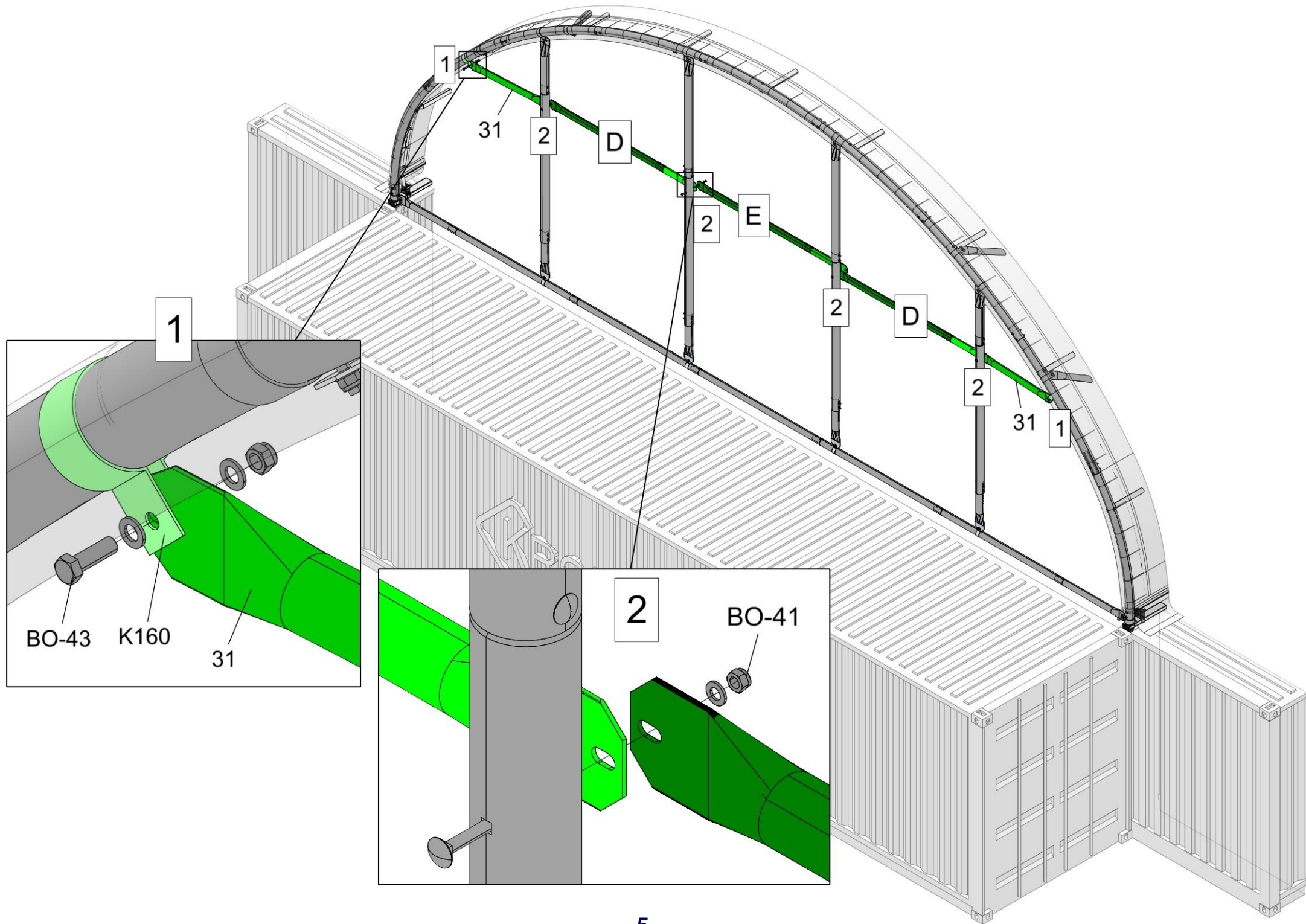

 Place "K145-1" clamps as close as possible to the vertical tubes and also on the lower part of the container wall.

 Platzieren Sie die "K145-1" Klemmen so nah wie möglich an den vertikalen Rohren und auch am unteren Teil der Containerwand.

 Placez les pinces "K145-1" aussi près que possible des tubes verticaux et également sur la partie inférieure du mur du conteneur.

